

# THULE®

SWEDEN

- GB** Fitting instructions
- D** Montageanleitung
- F** Instructions de montage
- NL** Montage-instructies
- I** Istruzioni per il montaggio
- E** Instrucciones de montaje
- PT** Instruções de Montagem
- S** Monteringsanvisning
- FIN** Asennusohje
- EST** Paigaldusjuhend
- LAT** Stiprināšanas instrukcija
- LIT** Pritvirtinimo instrukcijos
- PL** Instrukcja montażu
- RU** Инструкции по установке
- CZ** Návod na montáž
- SK** Návod na montáž
- SLO** Navodila za pritrjevanje
- HR** Uputa za sastavljanje
- HU** A felszerelés módja
- GR** Οδηγίες συναρμολόγησης
- TR** Montaj talimatları
- 中文 安装说明
- 日本語 取扱(取付)説明書
- 한국어 장착 지침
- ไทย คำแนะนำการติดตั้ง

*TOYOTA Hilux, 4-dr Double Cab, 05*

*TOYOTA Vigo, 4-dr Double Cab, 04*

## RAPID SYSTEM

### Kit 1350



## Follow me...

PROFESSIONAL  
**THULE**  
SWEDEN

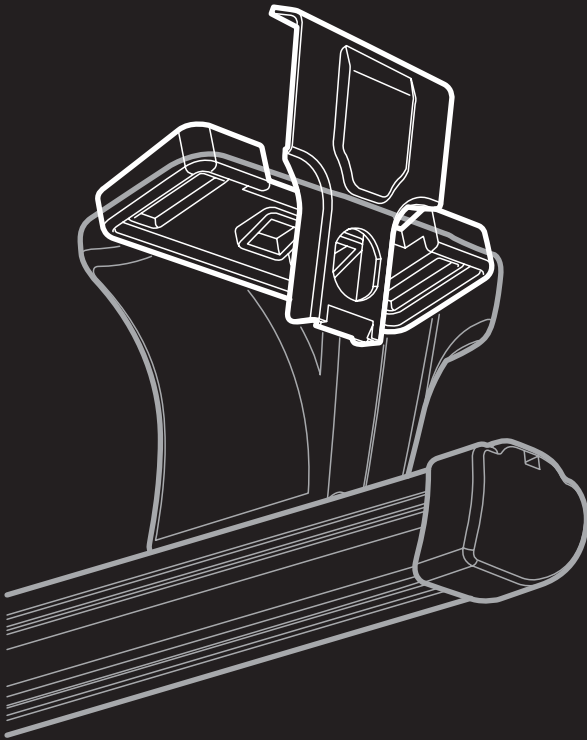

*TOYOTA Hilux, 4-dr Double Cab, 05*  
*TOYOTA Vigo, 4-dr Double Cab, 04*



Load Carrier  
**Kit 1350**  
121350

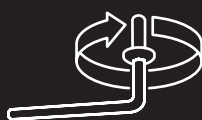

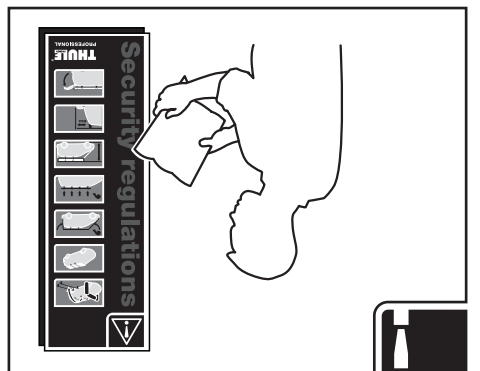
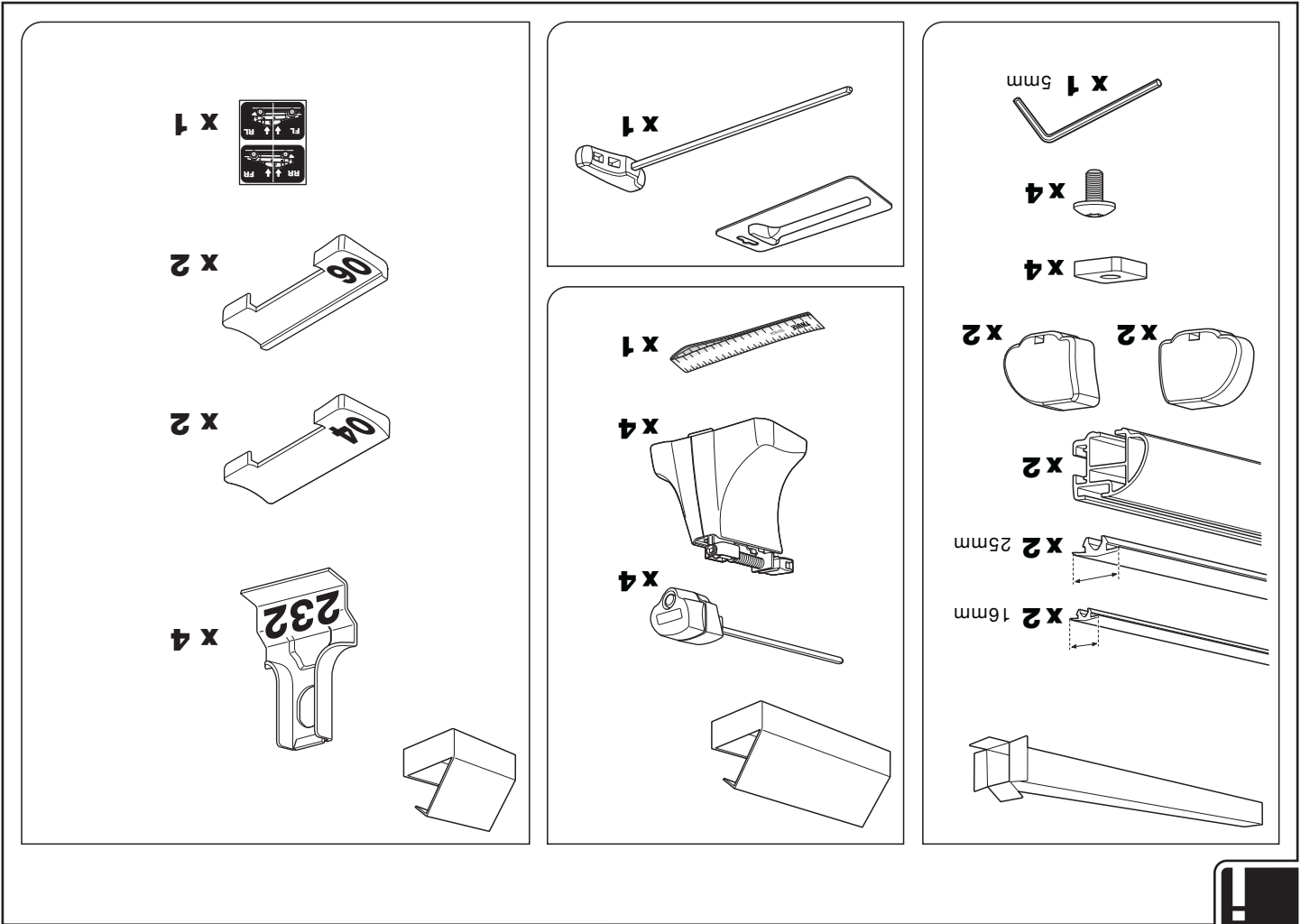
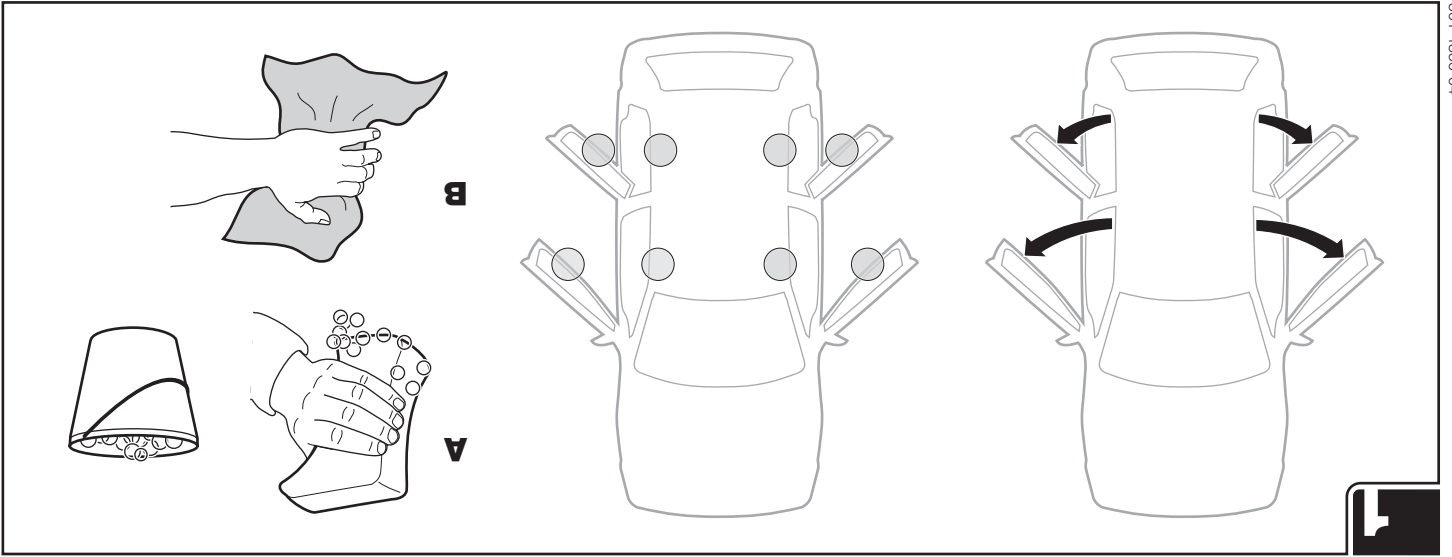

TOYOTA Hilux, 4-dr Double Cab, 05-	107,1 cm
TOYOTA Vigo, 4-dr Double Cab, 04-	107,1 cm

**Y**

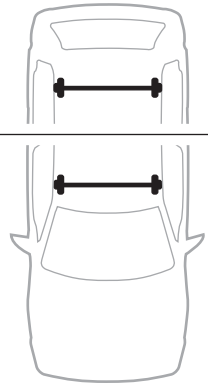
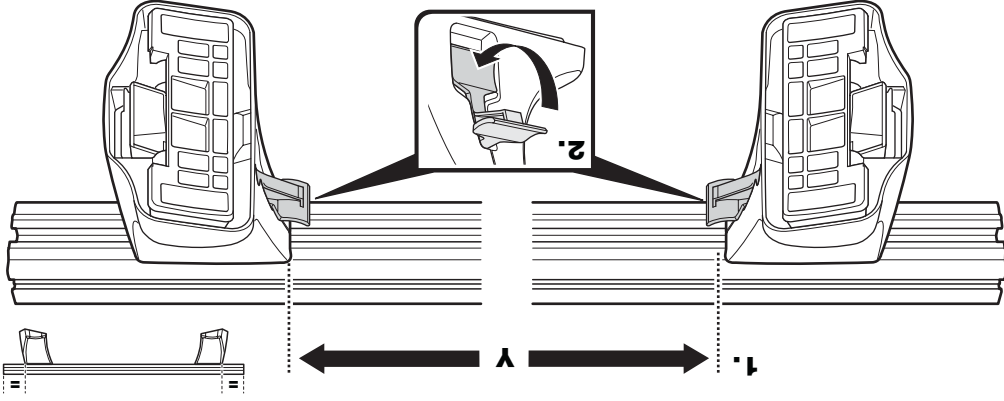

TOYOTA Hilux, 4-dr Double Cab, 05-	108,6 cm
TOYOTA Vigo, 4-dr Double Cab, 04-	108,6 cm

**X**

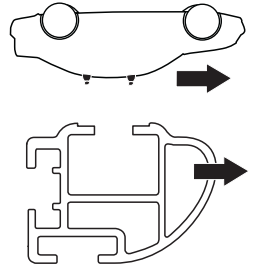
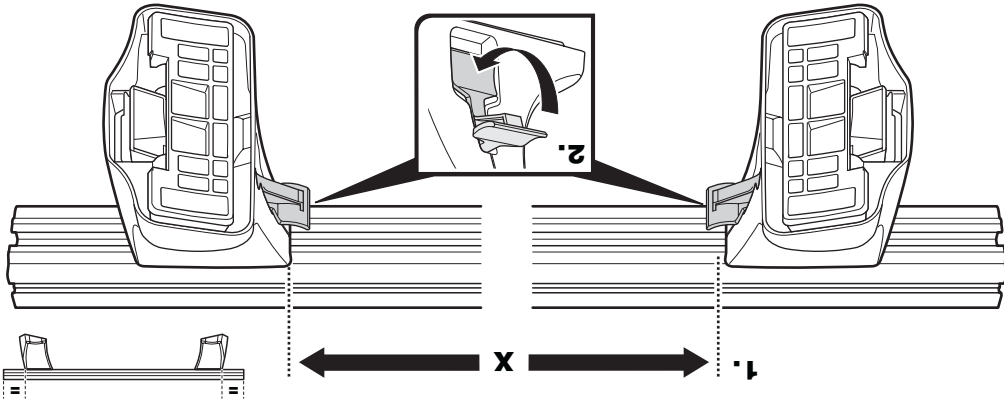

**3**

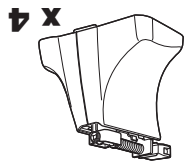
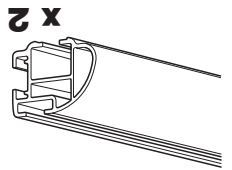
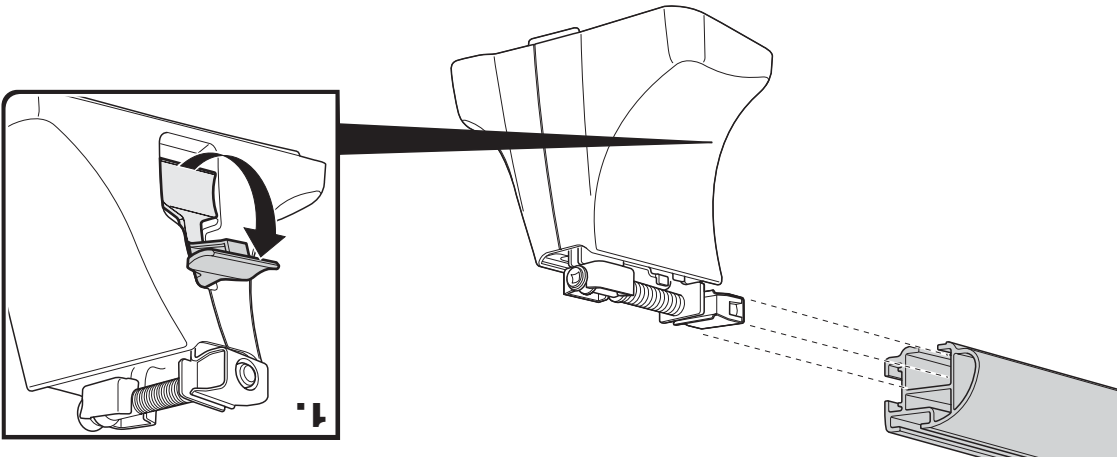

**2**

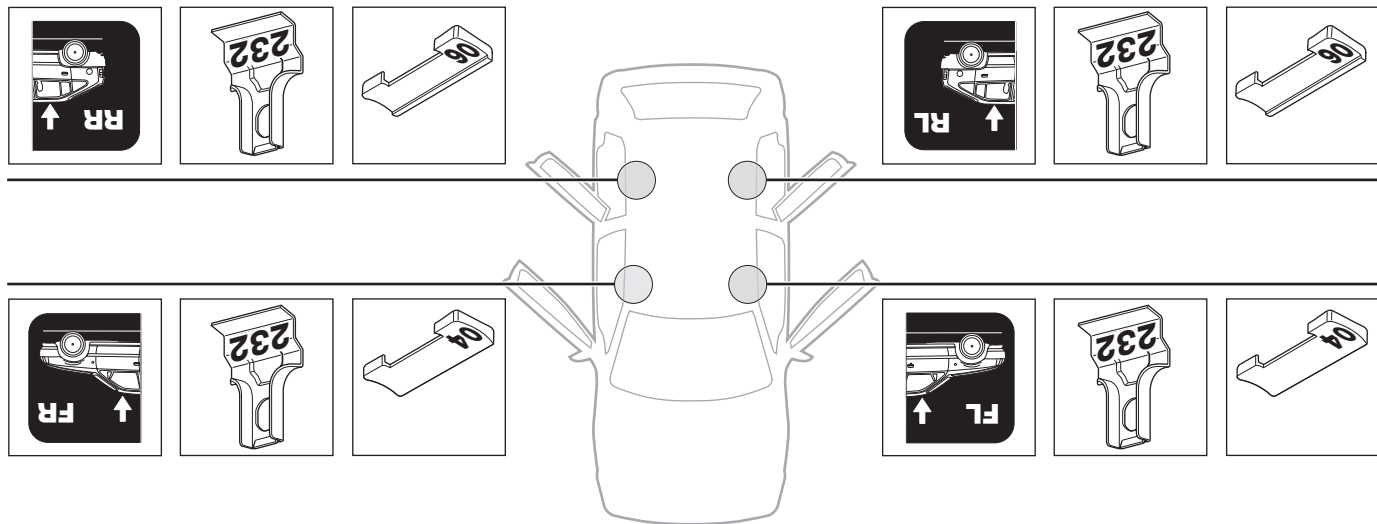

TOYOTA Hilux, 4-dr Double Cab, 05-  
TOYOTA Vigo, 4-dr Double Cab, 04-

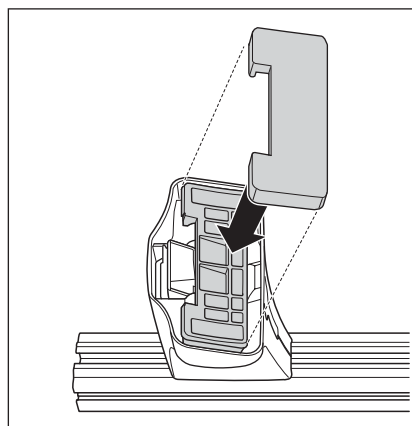
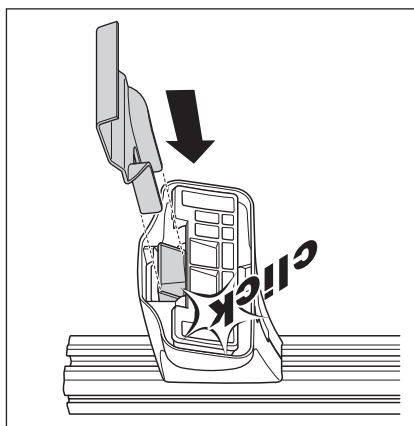
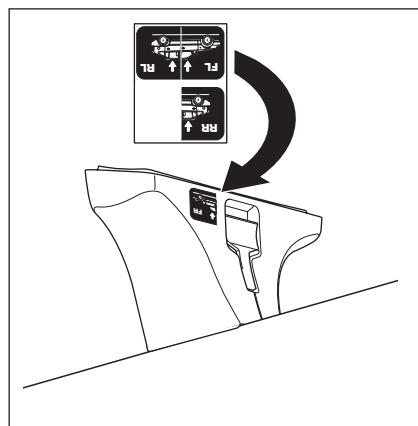

5

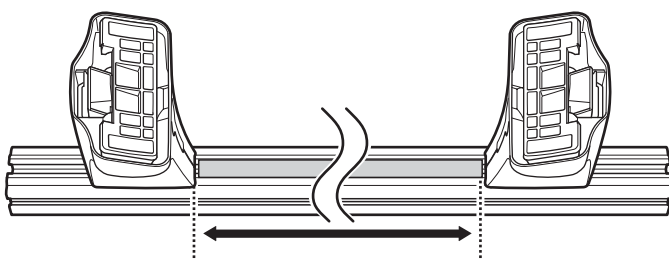
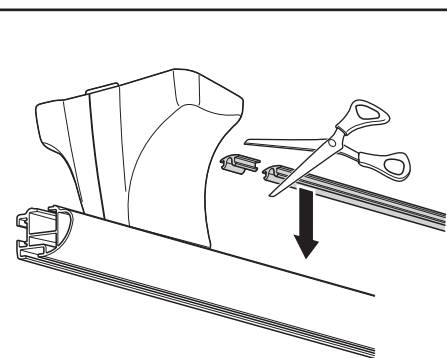

x2  
16mm

4

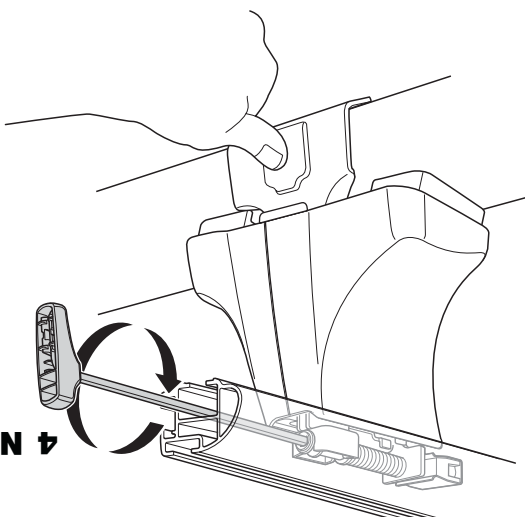
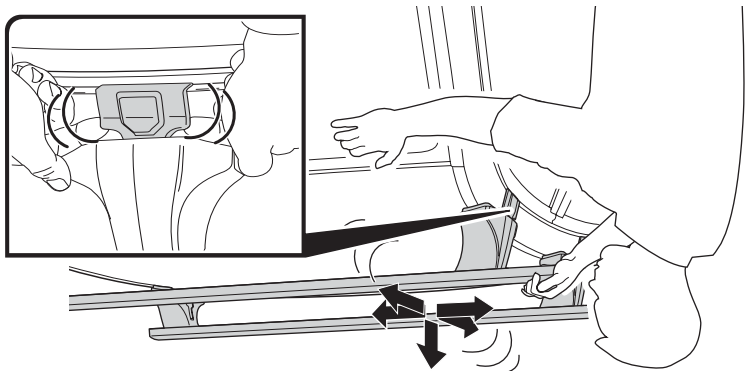
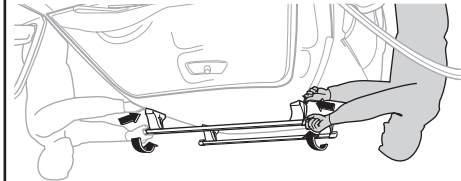

- GB** Tighten alternately
- D** Die Schrauben abwechselnd anziehen
- F** Serrer alternativement chaque côté
- NL** Afwisselend aan de linker- en de rechterkant aandraaien
- I** Serrare alternativamente
- E** Alternare il serraggio delle viti
- PT** Aperte alternadamente
- S** Dra åt växelvis
- FIN** Kierrä vuorotellen
- EST** Pinguldage vaheldumisi
- LAT** Pielieciet pamīšus
- LIT** Užsukinėkite pakaitomis
- PL** Śruby dokręcaj naprzemiennie
- RU** Затягивайте попеременно
- CZ** Pokrétta bagazníka dokręcaj
- SK** Dotiahujte striedavo
- SLO** Privijajte izmenično.
- HR** Naizmjenično zategnite
- HU** Egymástól függetlenül szorítandó
- GR** Ζφίγγετε εναλλάξ
- TR** Dönüşümlü sıkın
- 中文** 交替拧紧
- 한국어** 번갈아 가며 조이십시오.
- 日本語** 交互に締め付けてください。
- ไทย** ไขสลับกัน

501-1350-04

7

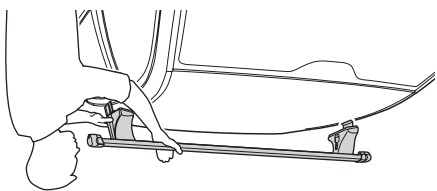
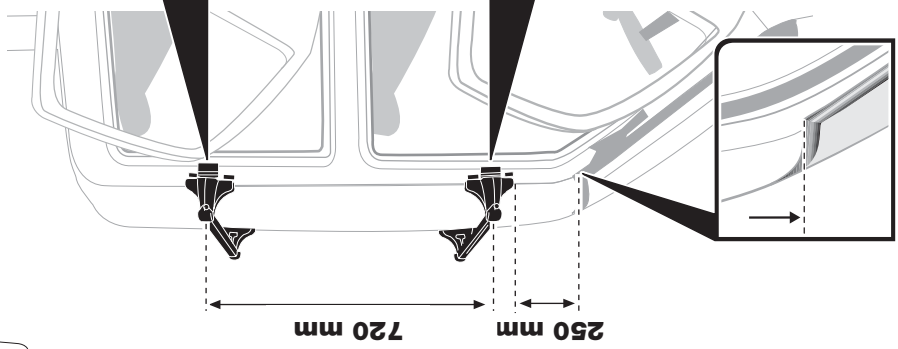
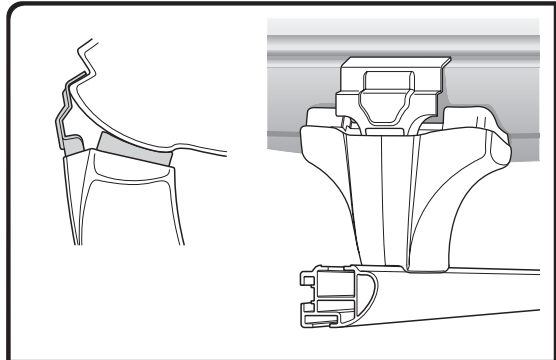
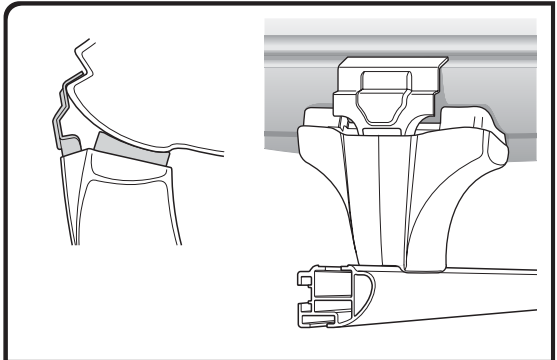

9

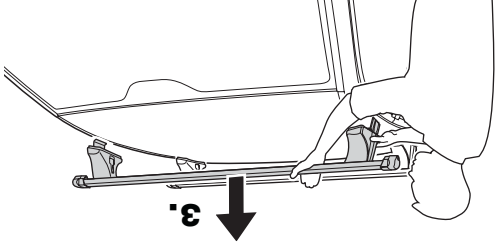
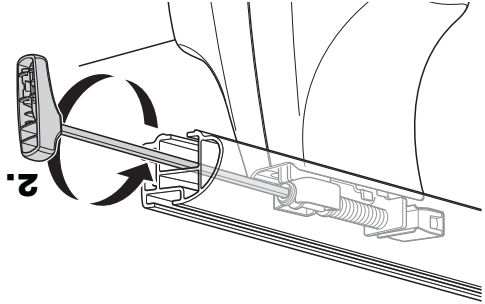
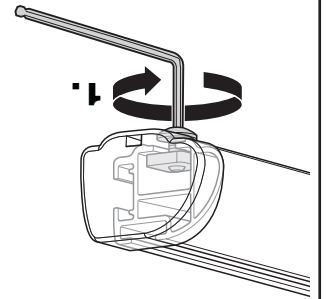
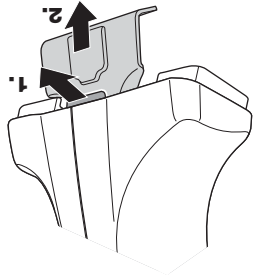

- GB** Removal
- D** Demontieren
- F** Démontage
- NL** Demontage
- I** Rimozione

- E** Desmontaje
- PT** Remoção
- S** Demontering
- FIN** Irrotus
- EST** Eemaldamine

- LAT** Noņemšana
- LIT** Nuėmimas
- PL** Wymontowanie
- RU** Чнятие
- CZ** Odmontování

- SK** Demontáž
- SLO** Odstranjevanje
- HR** Uklanjanje
- HU** Leszerelés
- GR** Αφαίρεση

- TR** Sökme
- 中文** 拆除
- 日本語** 取り外し
- 한국어** 분리
- ไทย** ถอดออก

**9**

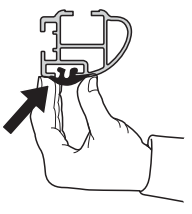
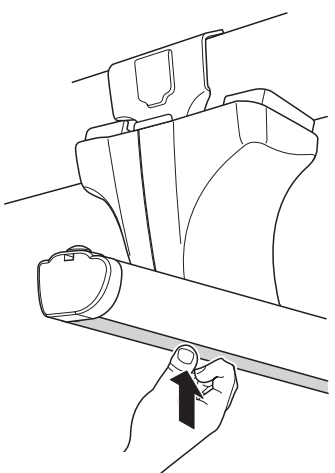
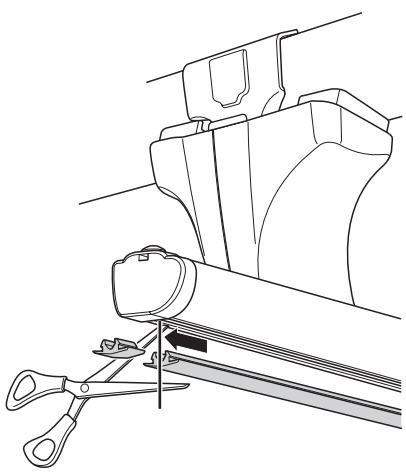
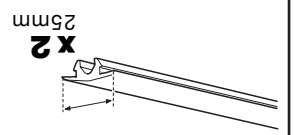

**8**

- x1** 5mm L-shaped trim piece
- x4** Screws
- x4** Spacers
- x2** Backrest covers
- x2** Backrest covers

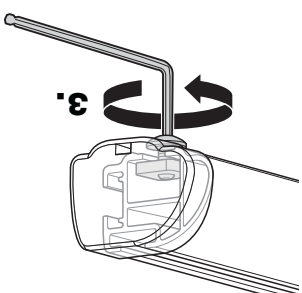
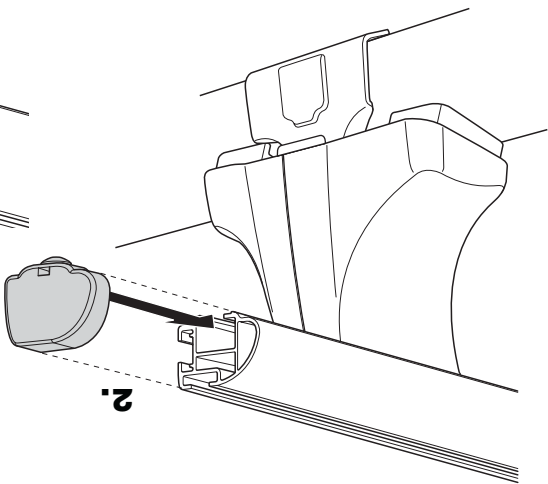
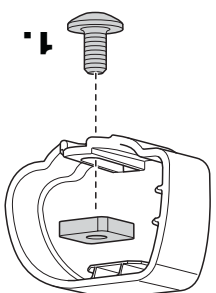



info@thule.com



www.thuleprofessional.com



Thule Sweden AB, Box 69, 330 33 Hillerstorp, SWEDEN

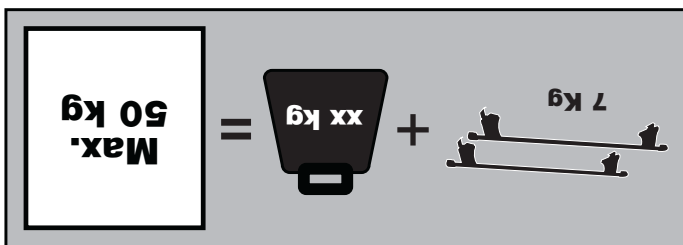
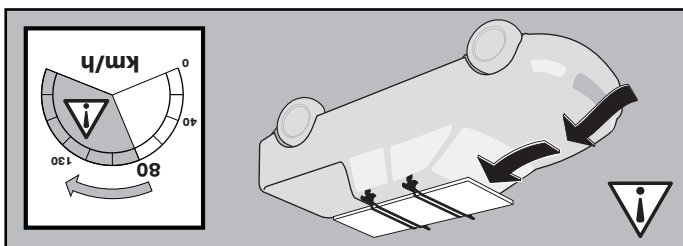
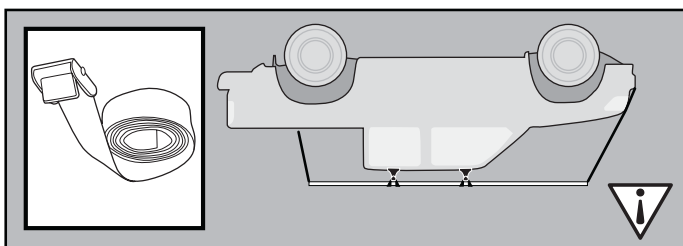







7 Kg + xx kg = **Max. 50 kg**

80 130  
40 0  
km/h

**THULE** 544  
**ONE** 596  
**KEY**  
**SYSTEM** 588

**GB** Removal  
**D** Demontieren  
**F** Démontage  
**NL** Demontage  
**I** Rimozione

**E** Desmontaje  
**PT** Remoção  
**S** Demonerung  
**FIN** Irrotus  
**EST** Eemaldamine

**LAT** Noņemšana  
**LIT** Nuėmimas  
**PL** Wymontowywanie  
**RU** СНЯТИЕ  
**CZ** Odmontování

**SK** Demontáž  
**SLO** Odstranjevanje  
**HR** Uklanjanje  
**HU** Leszerelés  
**GR** Αφαίρεση

**TR** Sökme  
 中文 拆除  
 日本語 取り外し  
 한국어 분리  
 ไทย การถอด

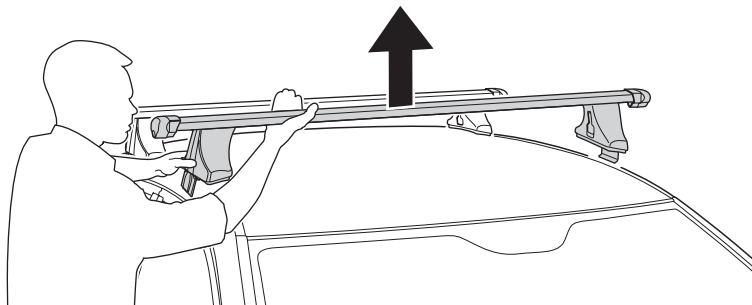
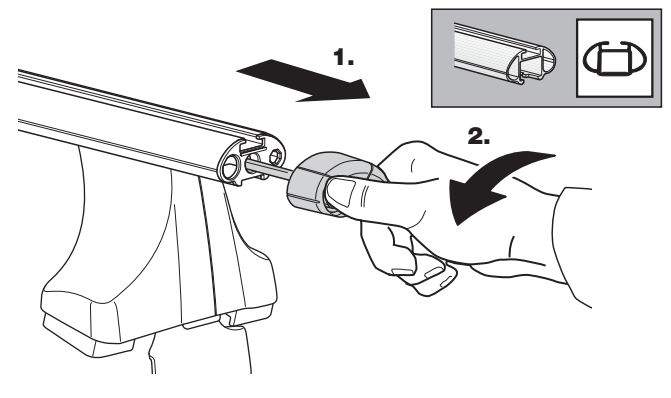
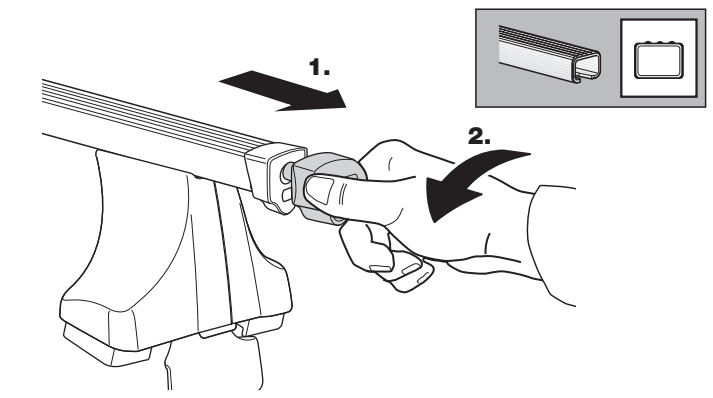

**Fit Tips!**

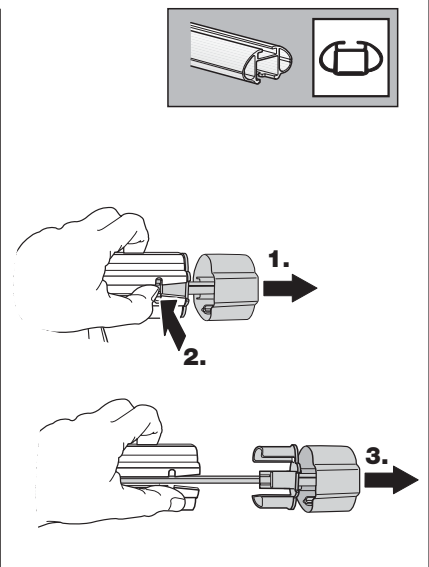
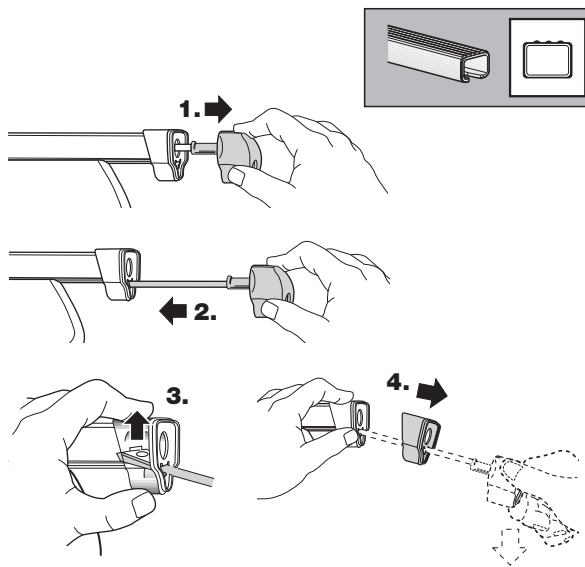
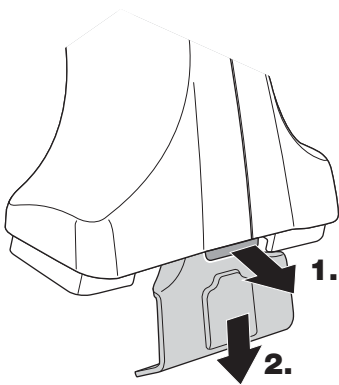

**THULE**  
**ONE**  
**KEY**  
**SYSTEM**

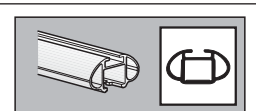
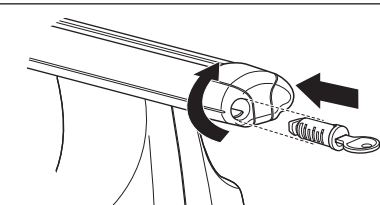
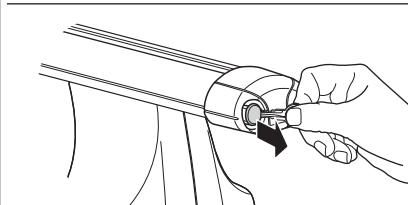
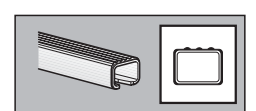
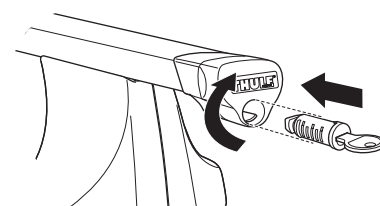
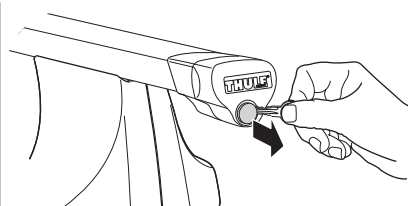
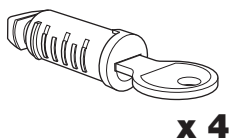

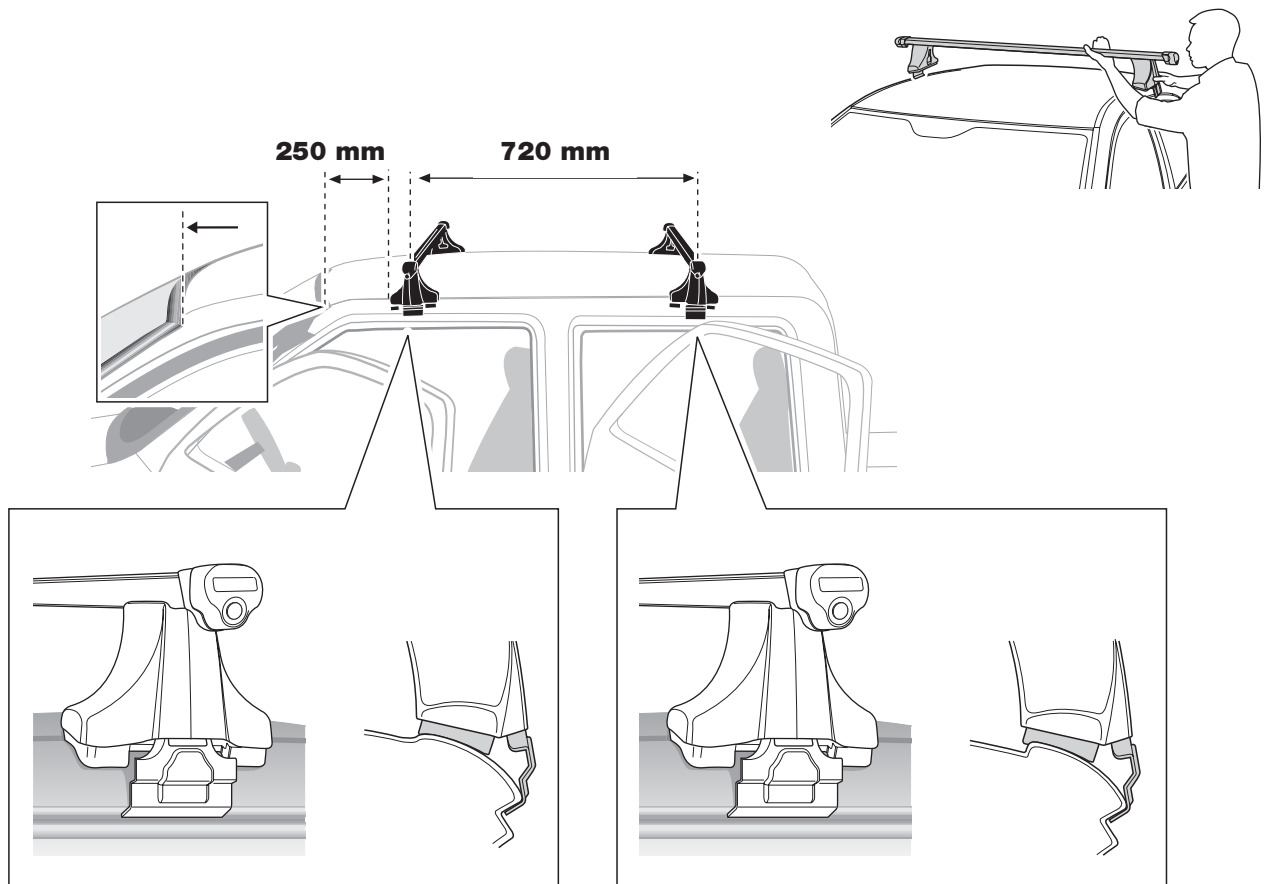
**6****7**

**GB** Tighten alternately  
**D** Die Schrauben abwechselnd anziehen  
**F** Serrer alternativement chaque côté  
**NL** Afwisselend aan de linker- en de rechterkant aandraaien  
**I** Serrare alternativamente  
**E** Alternare il serraggio delle viti  
**PT** Aperte alternadamente  
**S** Dra åt växelvis  
**FIN** Kierrä vuorotellen  
**EST** Pinguldage vaheldumisi  
**LAT** Pievelciet pamišus  
**LIT** Užsukinėkite pakaitomis

**PL** Śruby dokręcaj naprzemiennie  
**RU** Затягивайте попеременно  
**CZ** Pokręťta багаžníka dokręcaj dokręcaj naprzemiennie.  
**SK** Doťahujte striedavo  
**SLO** Privijajte izmenično.  
**HR** Naizmjenično zategnite  
**HU** Egymástól függetlenül szorítandó  
**GR** Σφίγγετε εναλλάξ  
**TR** Dönüşümlü sıkın  
**中文** 交替拧紧  
**한국어** 번갈아 가며 조이십시오.  
**日本語** 交互に締め付けてください。  
**ไทย** ชั้้นในแบบสลับ

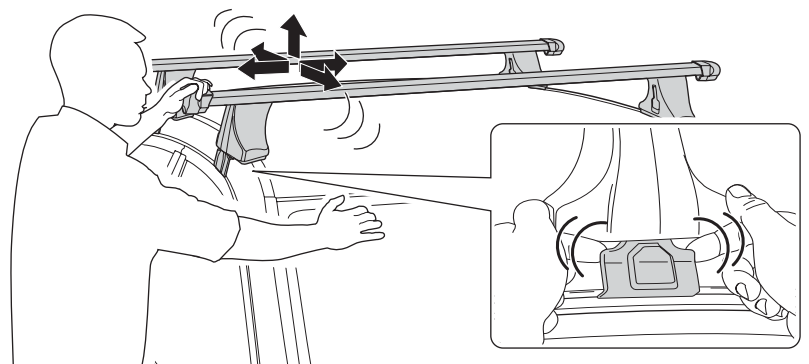
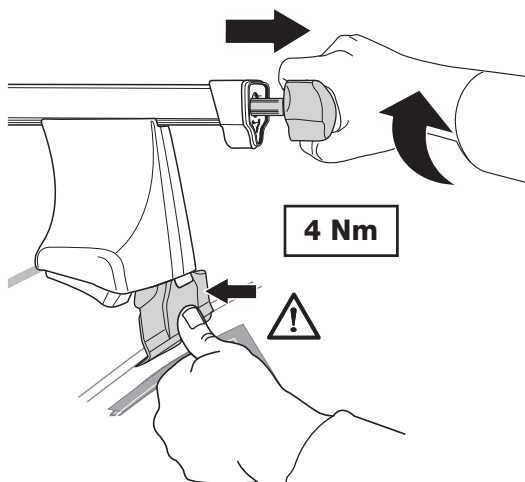
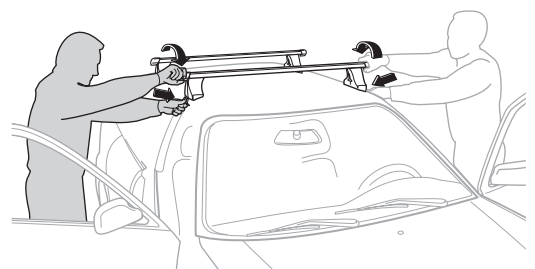

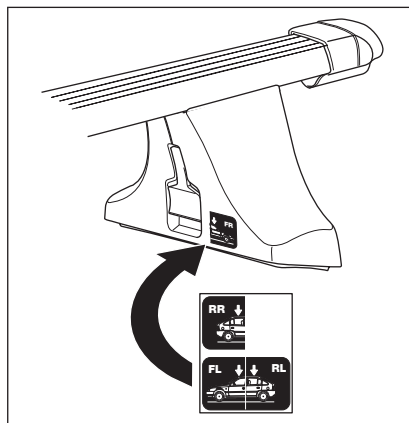
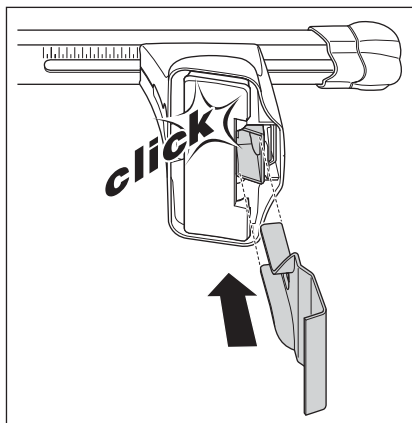
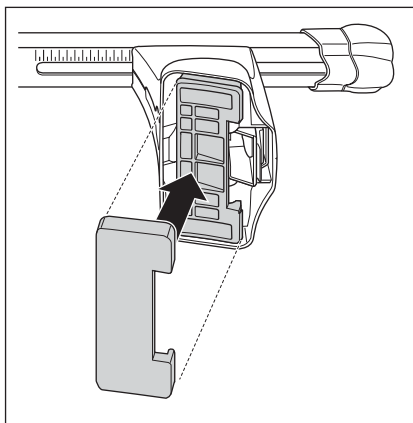

TOYOTA Hilux, 4-dr Double Cab, 05-  
TOYOTA Vigo, 4-dr Double Cab, 04-

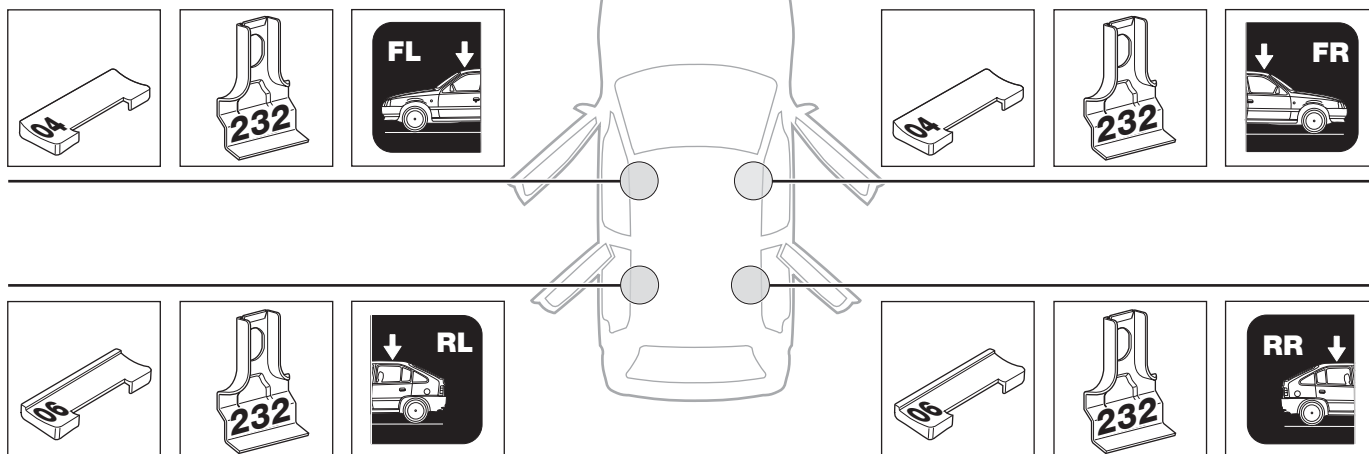

3

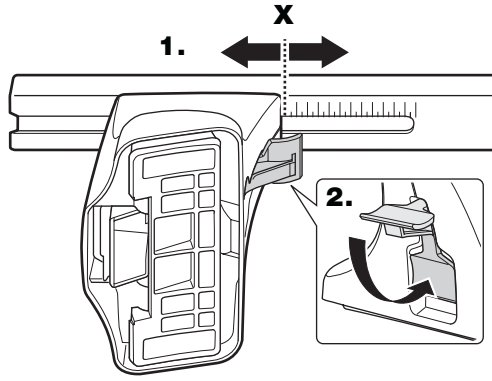
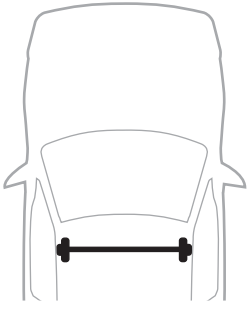

	<b>X</b>
TOYOTA Hilux, 4-dr Double Cab, 05-	43,5
TOYOTA Vigo, 4-dr Double Cab, 04-	43,5

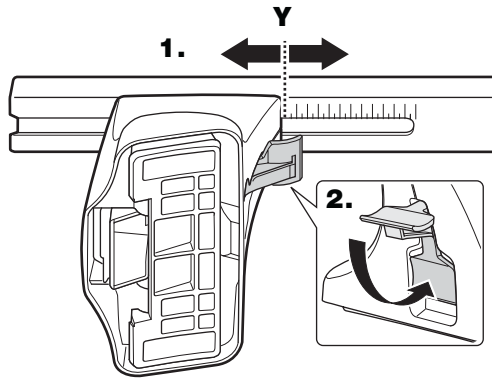
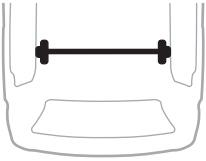

	<b>Y</b>
TOYOTA Hilux, 4-dr Double Cab, 05-	42
TOYOTA Vigo, 4-dr Double Cab, 04-	42

4

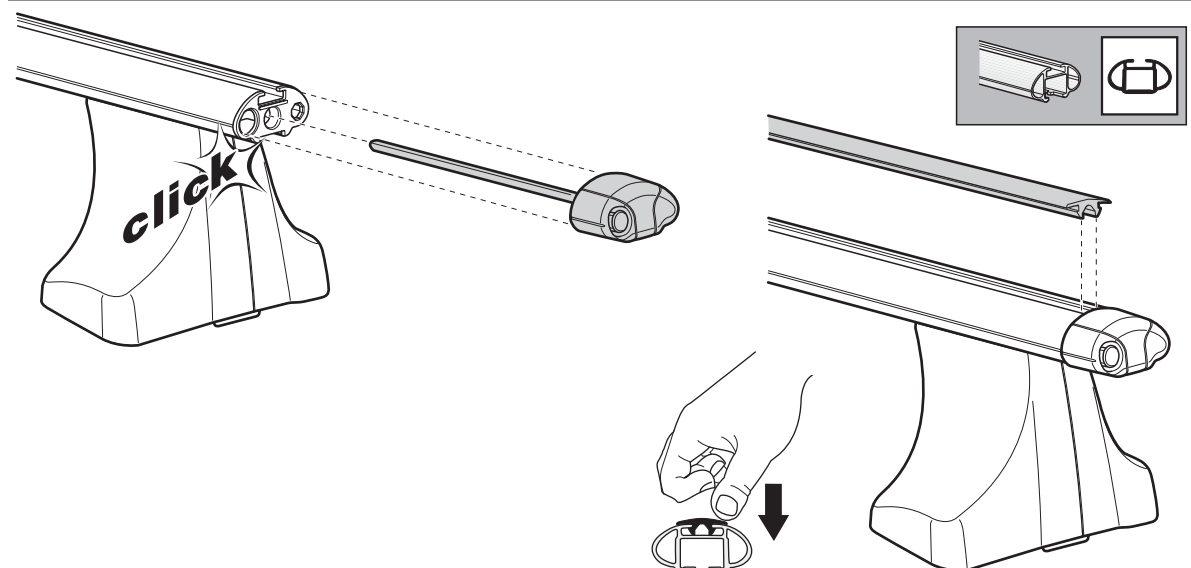
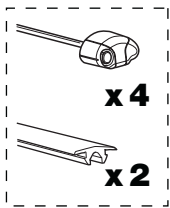
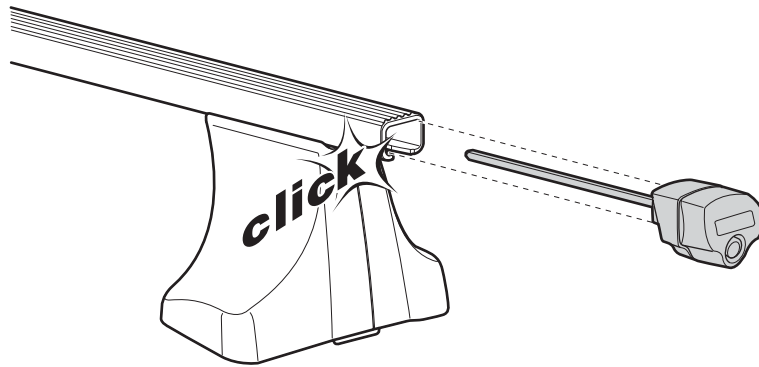
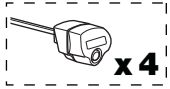

2

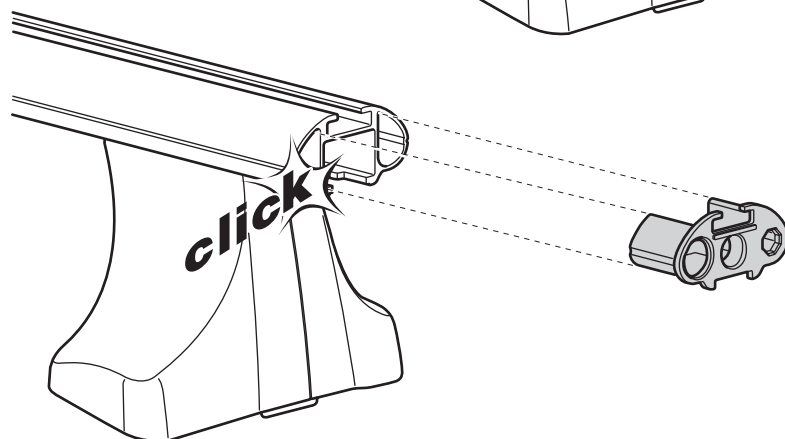
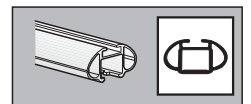
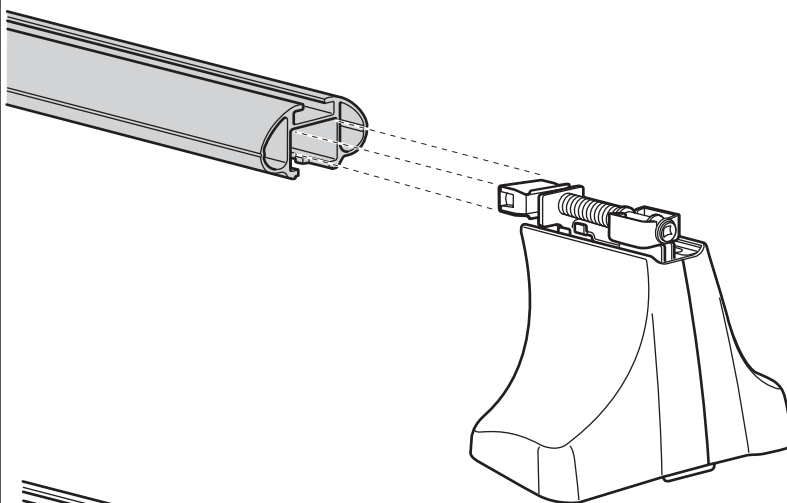
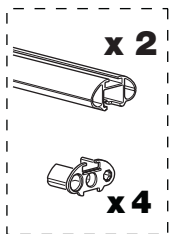
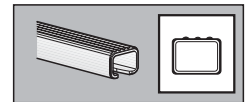
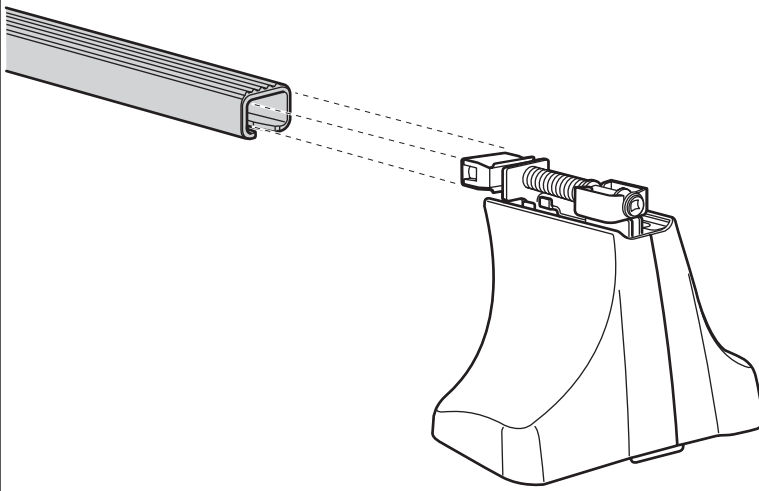
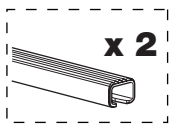
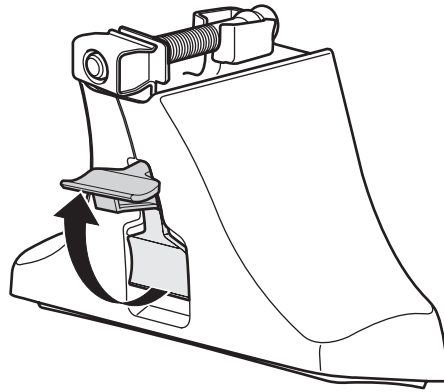
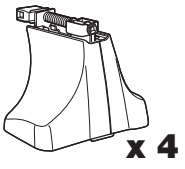

**THULE**  
SÄKERHET

**S** Säkerhetsinstruktioner  
**GB** Security regulations  
**D** Sicherheits-Vorschriften  
**F** Instructions importantes  
**NL** Veiligheidsvoorschriften  
**FIN** Turvallisuusohjeet  
**E** Reglas de seguridad  
**I** Norme di sicurezza  
**CZ** Nástroj na montáž  
**PL** Wykresy bezpieczeństwa  
**PT** Normas de segurança  
**GR** Ασφάλεια  
**TR** Güvenlik Talimatları  
**HU** Biztonsági előírások  
**RU** Инструкции по безопасности  
**HR** Pravila sigurnosti  
**EST** Ohutusjuhised  
**LIT** Saugumo taisyklės  
**LAT** Drošības noteikumi  
**SLO** Varnostni predpisi  
**KOR** 안전 주의 사항  
**THAI** ระเบียบความปลอดภัย  
**CHN** 安全注意事项

