

Kit 1448

SSANGYONG Actyon, 4-dr Double Cab, 06–
SSANGYONG Actyon, 5-dr SUV, 06–

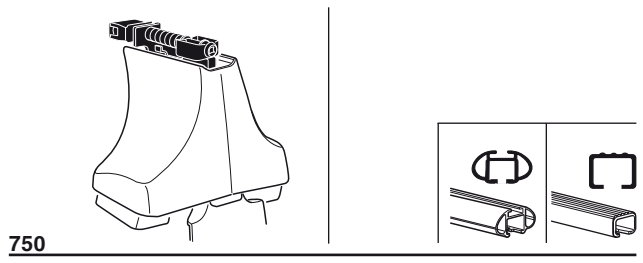
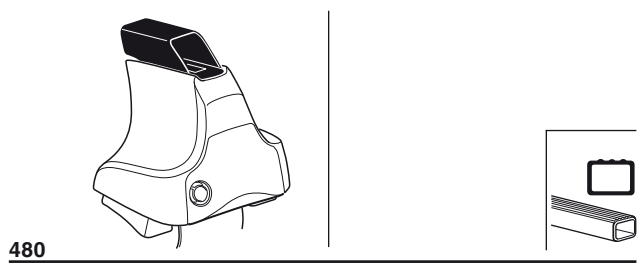
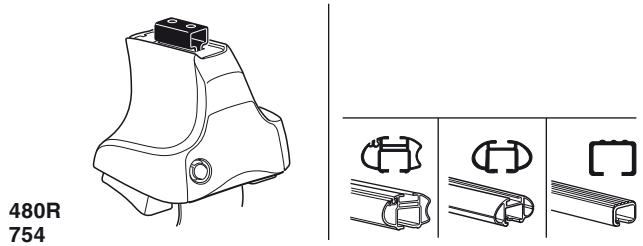

Max. 60 kg
Max. 132 lbs

Kit XXXX
 instructions

x1

x4

x4

x4

x4

480R/754

x1

x4

x4

x4

480

x1

x4

x4

750

x2 x2 x2 x4	x2	x2 x2 x4 x4	x2 x2	x2

902 x2

617 x2

217 x4

x1

Kit



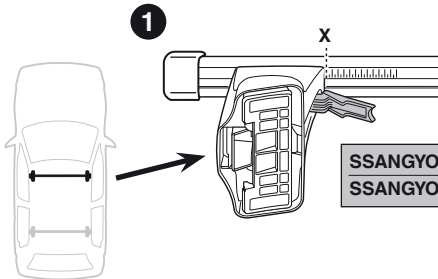

	X
SSANGYONG Actyon, 4-dr Double Cab, 06-	48
SSANGYONG Actyon, 5-dr SUV, 06-	48

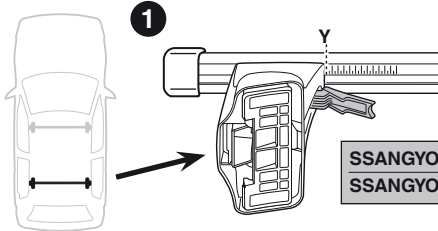

	Y
SSANGYONG Actyon, 4-dr Double Cab, 06-	44,5
SSANGYONG Actyon, 5-dr SUV, 06-	44,5

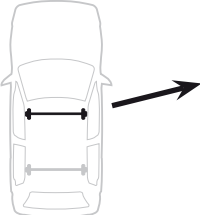
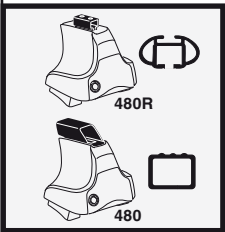

	X inch	X mm
SSANGYONG Actyon, 4-dr Double Cab, 06-	44 1/2"	1131 mm
SSANGYONG Actyon, 5-dr SUV, 06-	44 1/2"	1131 mm

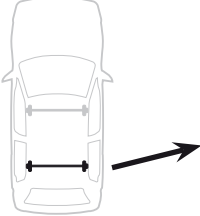

	Y inch	Y mm
SSANGYONG Actyon, 4-dr Double Cab, 06-	43 1/8"	1096 mm
SSANGYONG Actyon, 5-dr SUV, 06-	43 1/8"	1096 mm

4

SSANGYONG Actyon, 4-dr Double Cab, 06-
SSANGYONG Actyon, 5-dr SUV, 06-

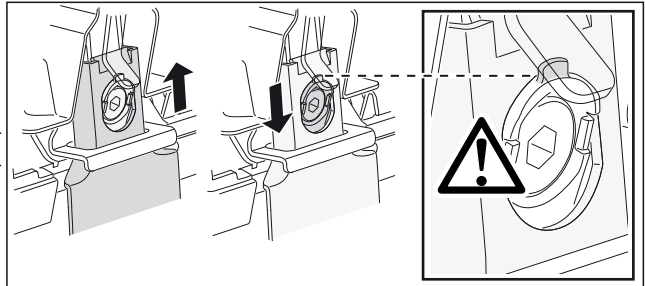
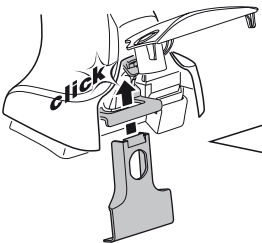
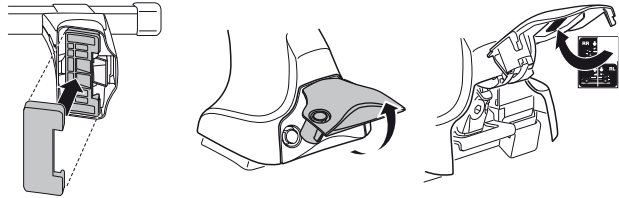
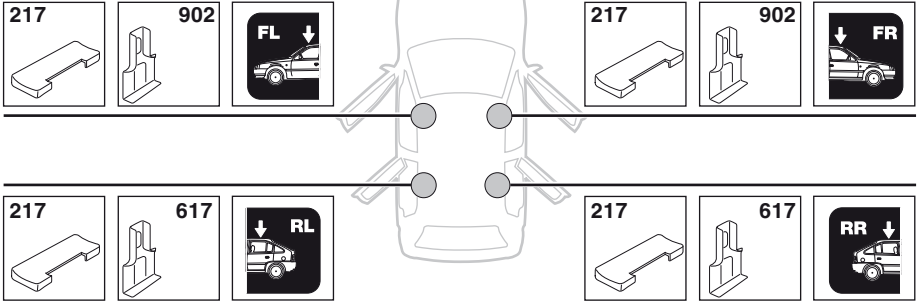

5



	X mm	Y mm	X inch	Y inch
SSANGYONG Actyon, 4-dr Double Cab, 06–	270 mm	700 mm	10 ⁵ / ₈ ”	27 ¹ / ₂ ”
SSANGYONG Actyon, 5-dr SUV, 06–	270 mm	700 mm	10 ⁵ / ₈ ”	27 ¹ / ₂ ”

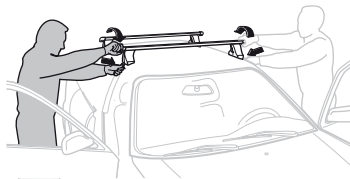
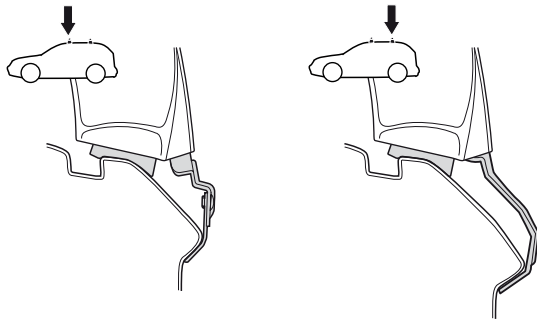
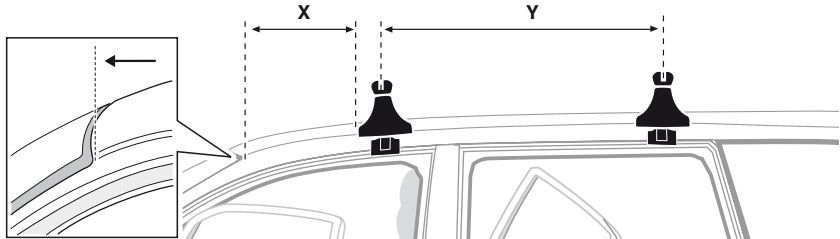

GB/US Tighten alternately

D Die Schrauben abwechselnd anziehen

F Serrer alternativement chaque côté

NL Afwisselend aan de linker- en de rechterkant aandraaien

I Alternare il serraggio delle viti

E Apretar alternativamente

PT Aperte alternadamente

S Dra åt växelvis

FIN Kierrä vuorotellen

EST Pinguldage vaheldumisi

LAT Pielieciet pamišus

LIT Užsukinkite pakaitomis

PL Śruby dokręcaj naprzemiennie

RU Затягивайте попеременно

CZ Pokręťta bagażníka dokręcaj dokręcaj naprzemiennie.

SK Doťahujte striedavo

SLO Privijajte izmenično.

HR Naizmjenično zategnite

HU Egymástól függetlenül szorítandó

GR Σφίγγετε εναλλάξ

TR Dönüşümlü sıkın

中文 交替拧紧

한국어 번갈아 가며 조이십시오.

日本語 交互に締め付けてください。

ไทย ชันในแบบสลับ

6



480R/754



480

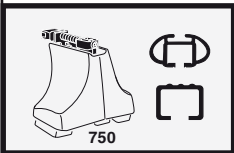
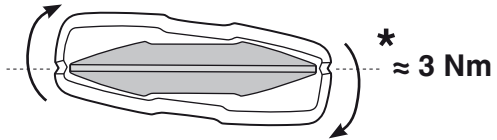
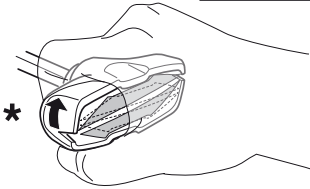
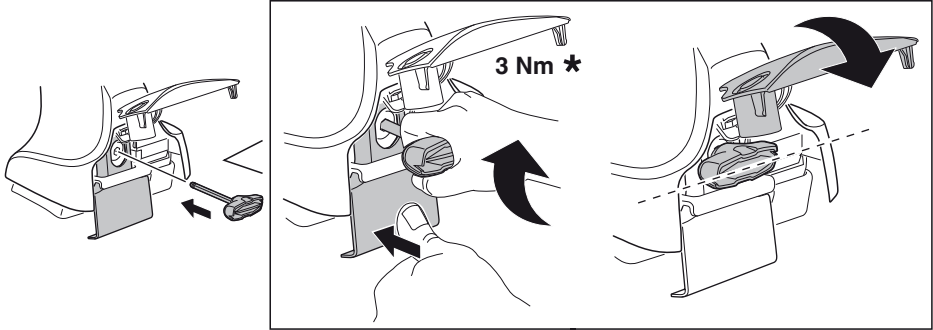

750

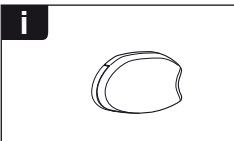
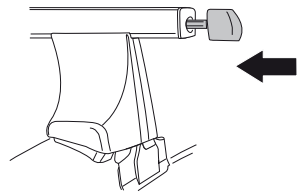
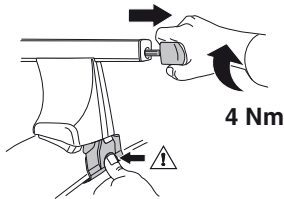

1

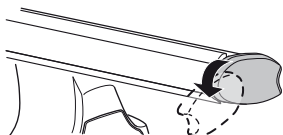

2

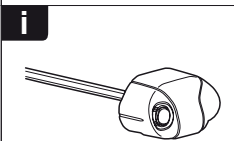
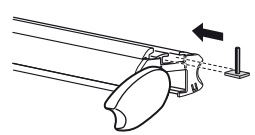

1

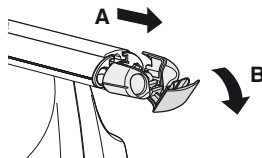

2

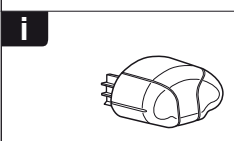
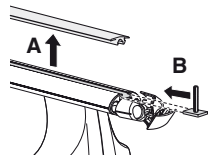

1

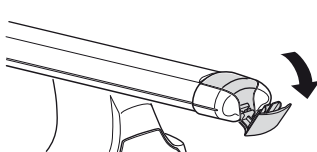

2

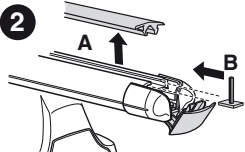

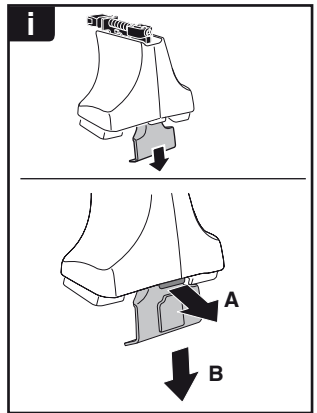
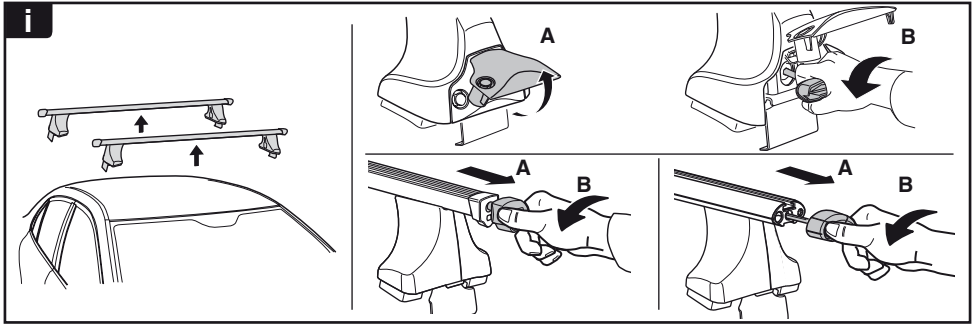

THULE
SWEDEN
**ONE
KEY
SYSTEM**



- 544 (x4)
- 596 (x6)
- 588 (x8)
- NA 510 (x10)
- EUR 452 (x12)
- ASIA



WW ▶ Thule Sweden AB, Box 69, 330 33 Hillerstorp, SWEDEN
NA ▶ Thule Inc., 42 Silvermine Road, Seymour, Connecticut 06483, USA

info@thule.com
customer.service@thule.com

www.thule.com