

Kit 1499

OPEL Agila, 5-dr Hatchback, 08–
SUZUKI Splash, 5-dr Hatchback, 08–

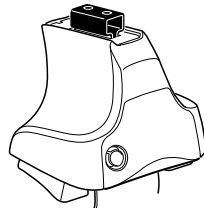

480R Rapid Traverse
754 Rapid System

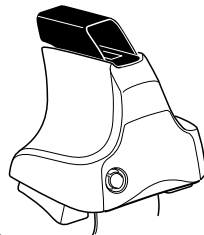
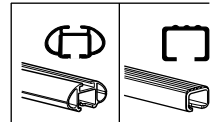

480 Traverse



Kit

1



480R Rapid Traverse
754 Rapid System



480 Traverse

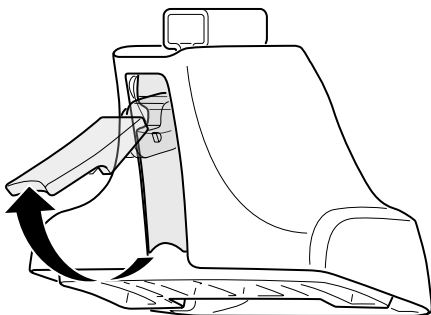

2



480R Rapid Traverse
754 Rapid System



480 Traverse

+

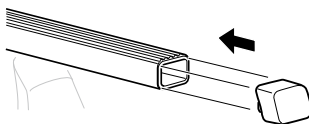
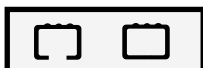
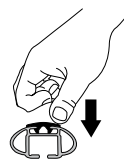
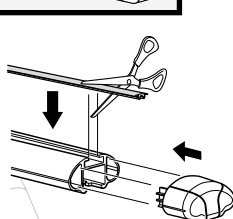
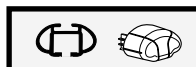
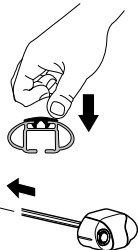
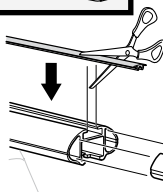
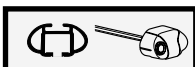
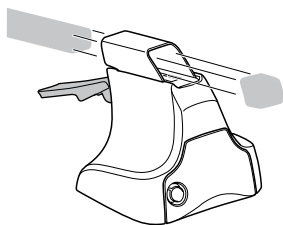
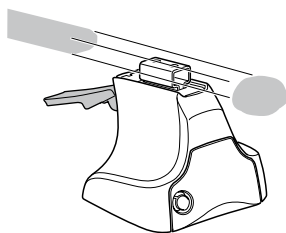

3

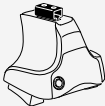

754 Rapid System

1

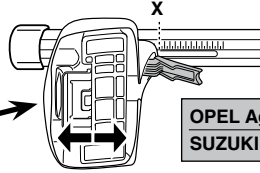
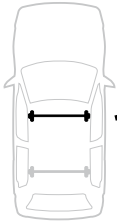

2

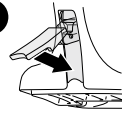

	X
OPEL Agila, 5-dr Hatchback, 08-	28,5
SUZUKI Splash, 5-dr Hatchback, 08-	28,5

1

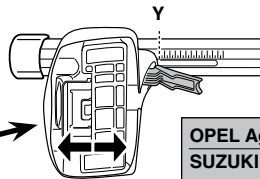

2

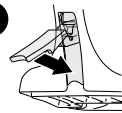

	Y
OPEL Agila, 5-dr Hatchback, 08-	27
SUZUKI Splash, 5-dr Hatchback, 08-	27



480R Rapid Traverse



480 Traverse

1

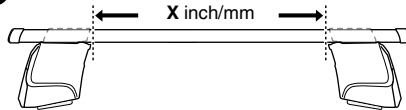

2

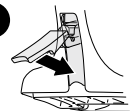

	X inch	X mm
OPEL Agila, 5-dr Hatchback, 08-	36 ⁷ / ₈ "	936 mm
SUZUKI Splash, 5-dr Hatchback, 08-	36 ⁷ / ₈ "	936 mm

1

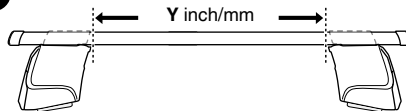

2

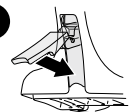

	Y inch	Y mm
OPEL Agila, 5-dr Hatchback, 08-	36 ¹ / ₄ "	921 mm
SUZUKI Splash, 5-dr Hatchback, 08-	36 ¹ / ₄ "	921 mm

4

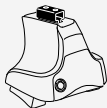

480R Rapid Traverse
754 Rapid System



480 Traverse

OPEL Agila, 5-dr Hatchback, 08-
SUZUKI Splash, 5-dr Hatchback, 08-

343

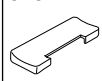

1103

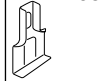

344

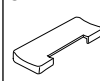

1103

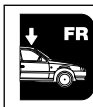
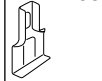

15

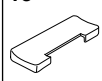

1103

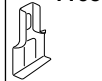

15

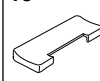

1103

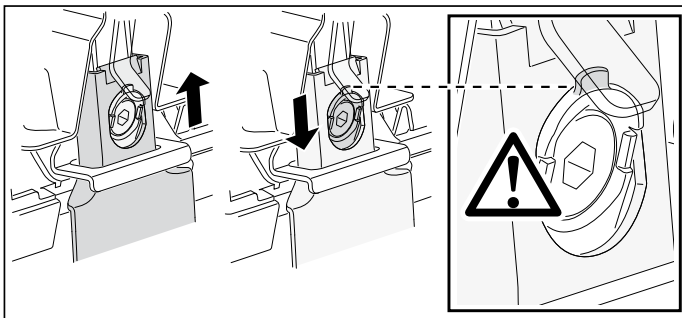
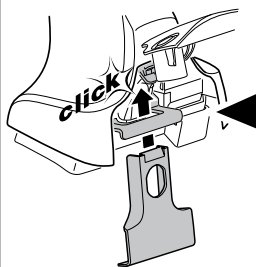
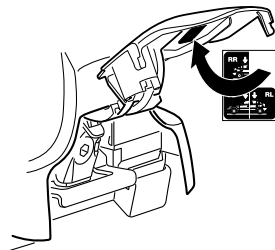
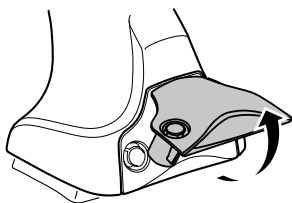
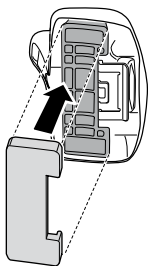
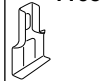

5



	X mm	Y mm	X inch	Y inch
OPEL Agila, 5-dr Hatchback, 08-	270 mm	700 mm	10 ⁵ / ₈ "	27 ¹ / ₂ "
SUZUKI Splash, 5-dr Hatchback, 08-	270 mm	700 mm	10 ⁵ / ₈ "	27 ¹ / ₂ "

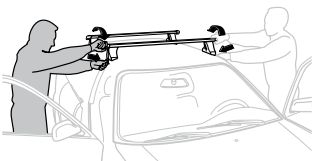
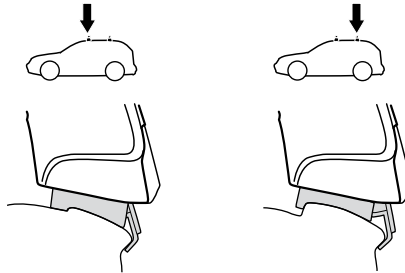
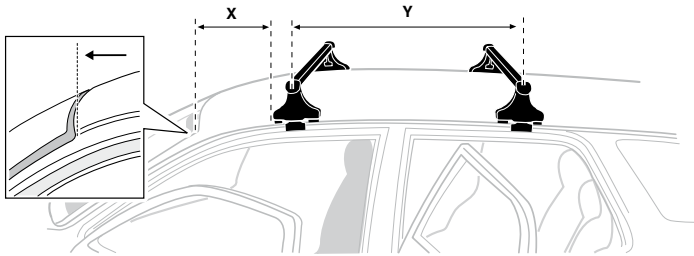

- | | | | |
|--------------|---|------------|---|
| GB/US | Tighten alternately | CZ | Pokreťta bagazníka dokrečaj dokrečaj naprzemiennie. |
| D | Die Schrauben abwechselnd anziehen | SK | Dofahujte striedavo |
| F | Serrer alternativement chaque côté | SLO | Privijajte izmenično. |
| NL | Afwisselend aan de linker- en de rechterkant aandraaien | HR | Naizmjenično zategniti |
| I | Alternare il serraggio delle viti | HU | Egy mástól függetlenül szorítandó |
| E | Apretar alternativamente | GR | Σφιγγετε εναλλάξ |
| PT | Aperte alternadamente | TR | Dönüşümlü sıkın |
| S | Dra åt växelvis | 中文 | 交替拧紧 |
| FIN | Kierrä vuorotellen | 한국어 | 번갈아 가며 조이십시오. |
| EST | Pinguldage vaheldumisi | 日本語 | 交互に締め付けてください。 |
| LAT | Pievēciēt pamāšus | ไทย | ขันในแบบสลับ |
| LIT | Užsukinėkite pakaitomis | | |
| PL | Śruby dokrećaj naprzemiennie | | |
| RU | Затягивайте попеременно | | |

6

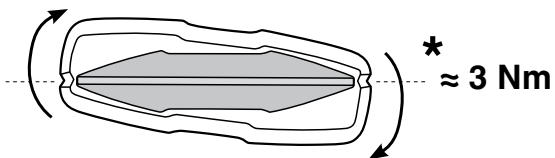
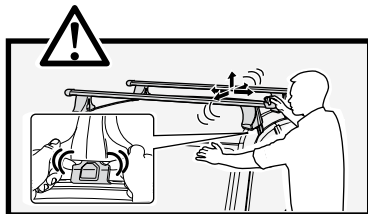
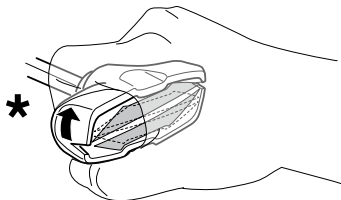
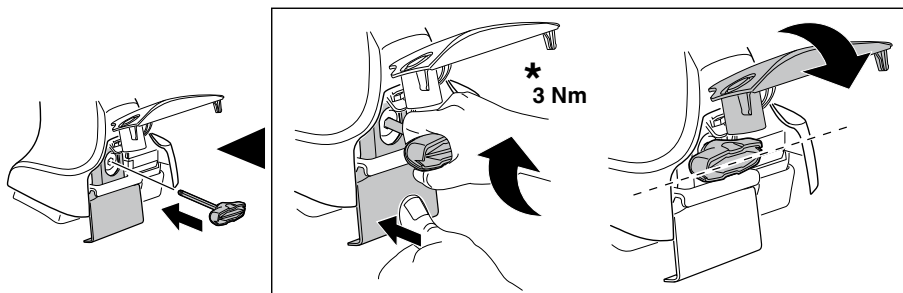
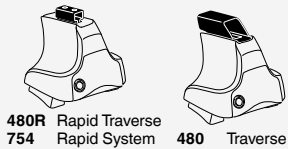

7

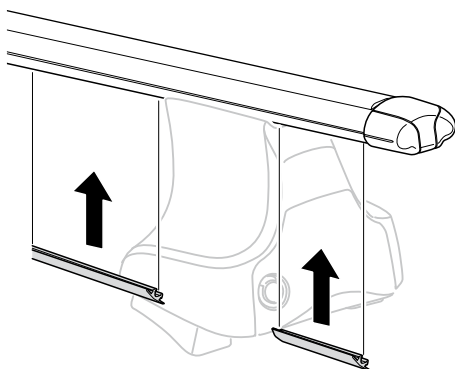
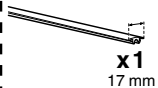

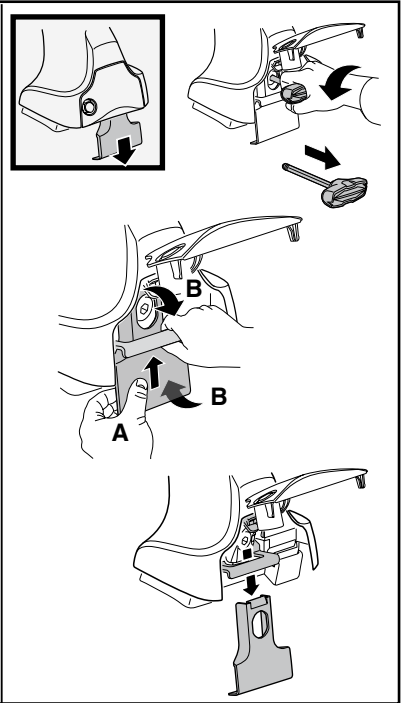
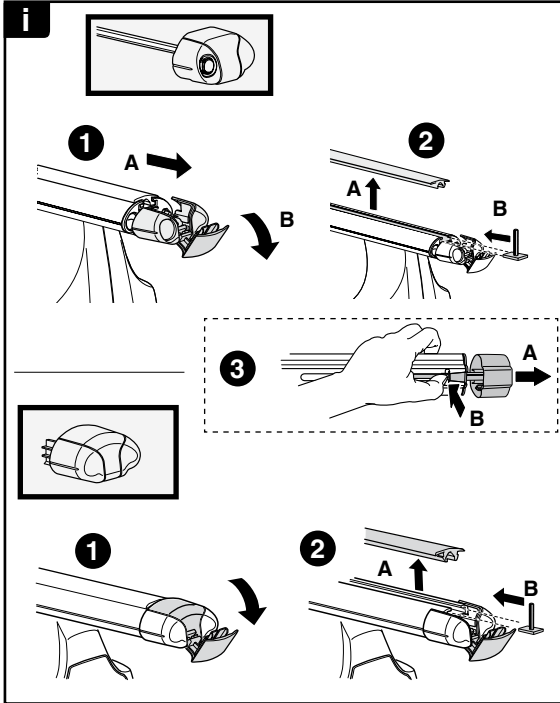

THULE
SWEDEN
**ONE
KEY
SYSTEM**

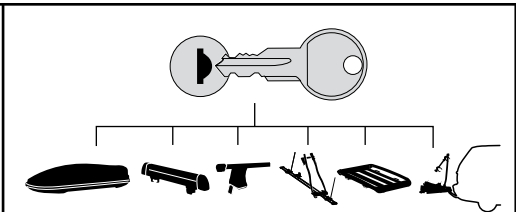

		(x4)
		(x6)
		(x8)
NA		(x10)
EUR		(x12)
ASIA		



WW ▶ Thule Sweden AB, Box 69, 330 33 Hillerstorp, SWEDEN
NA ▶ Thule Inc., 42 Silvermine Road, Seymour, Connecticut 06483, USA

info@thule.com
customer.service@thule.com

www.thule.com