

# Kit 1512

PONTIAC Vibe, 5-dr Hatchback, 03-08, 09-\*

TOYOTA Matrix, 5-dr Hatchback, 03-08, 09-\*

\* w/o factory rack

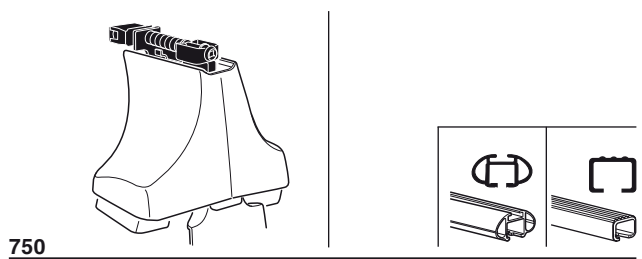
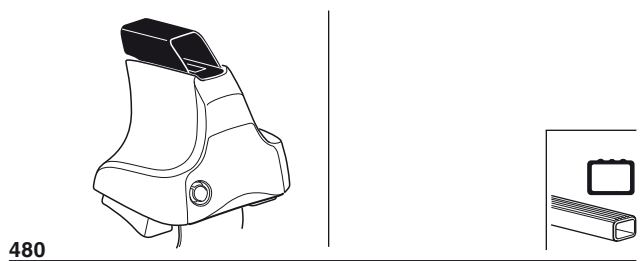
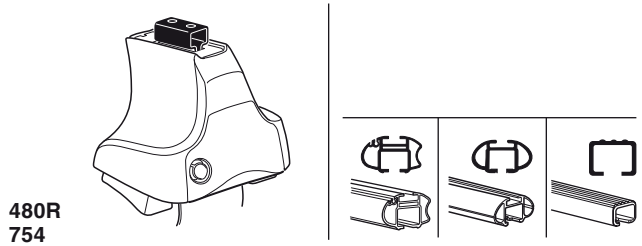

**Kit**

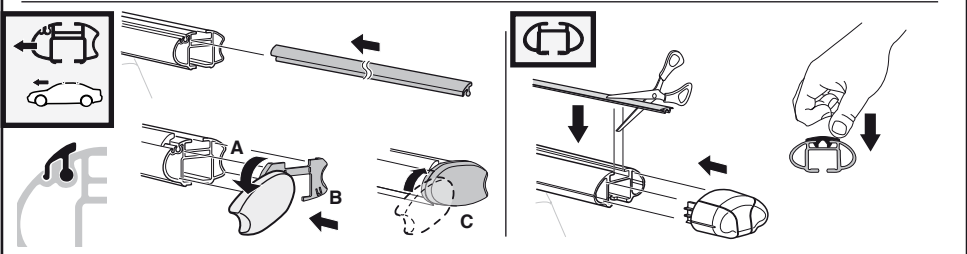
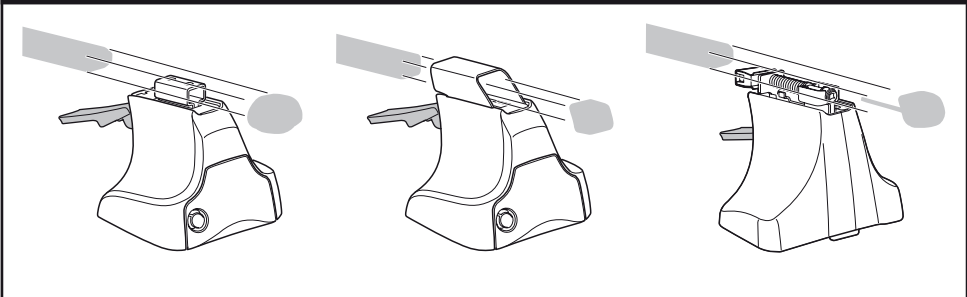

**3**

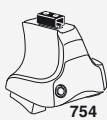

754

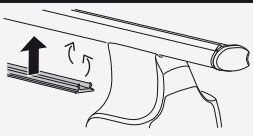
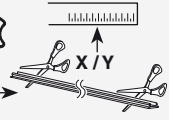

750



**1**

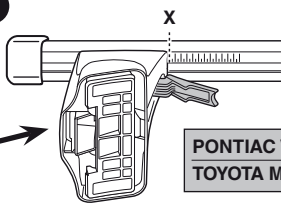
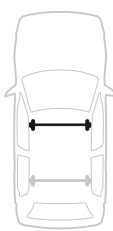

**2**

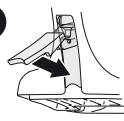

	X
<b>PONTIAC Vibe, 5-dr Hatchback, 03-08, 09-</b>	<b>30</b>
<b>TOYOTA Matrix, 5-dr Hatchback, 03-08, 09-</b>	<b>30</b>

**1**

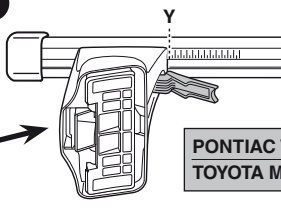

**2**



	Y
<b>PONTIAC Vibe, 5-dr Hatchback, 03-08, 09-</b>	<b>34</b>
<b>TOYOTA Matrix, 5-dr Hatchback, 03-08, 09-</b>	<b>34</b>



480R



480



**1**

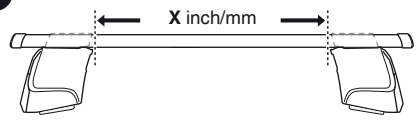

**2**



	X inch	X mm
<b>PONTIAC Vibe, 5-dr Hatchback, 03-08, 09-</b>	<b>37 1/2"</b>	<b>950 mm</b>
<b>TOYOTA Matrix, 5-dr Hatchback, 03-08, 09-</b>	<b>37 1/2"</b>	<b>950 mm</b>

**1**

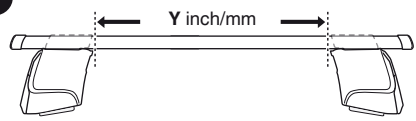

**2**



	Y inch	Y mm
<b>PONTIAC Vibe, 5-dr Hatchback, 03-08, 09-</b>	<b>39"</b>	<b>990 mm</b>
<b>TOYOTA Matrix, 5-dr Hatchback, 03-08, 09-</b>	<b>39"</b>	<b>990 mm</b>

# 4

PONTIAC Vibe, 5-dr Hatchback, 03-08, 09-  
 TOYOTA Matrix, 5-dr Hatchback, 03-08, 09-

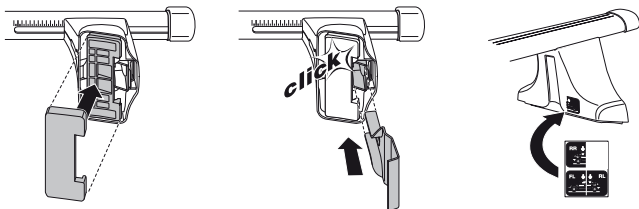
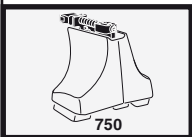
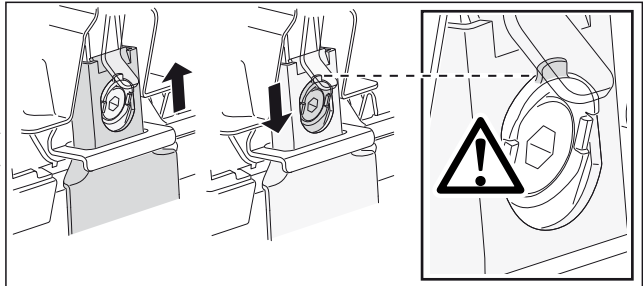
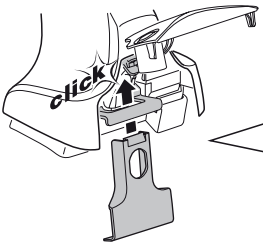
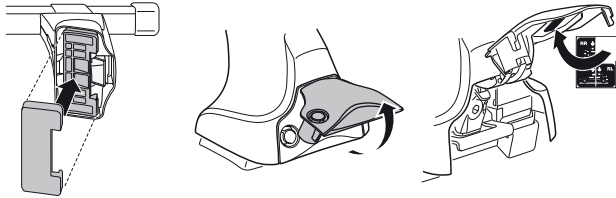
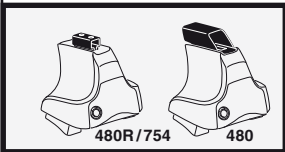
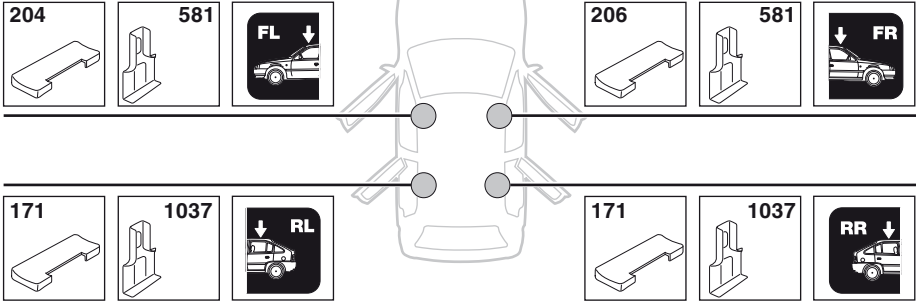

5

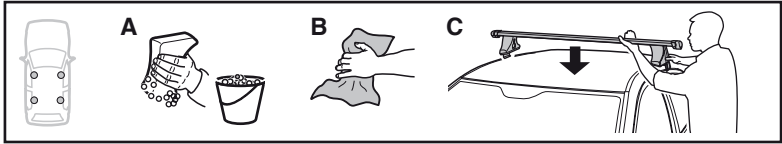

	X mm	Y mm	X inch	Y inch
<b>PONTIAC Vibe</b> , 5-dr Hatchback, 03-08, 09-	<b>380 mm</b>	<b>680 mm</b>	<b>15"</b>	<b>26 3/4"</b>
<b>TOYOTA Matrix</b> , 5-dr Hatchback, 03-08, 09-	<b>380 mm</b>	<b>680 mm</b>	<b>15"</b>	<b>26 3/4"</b>

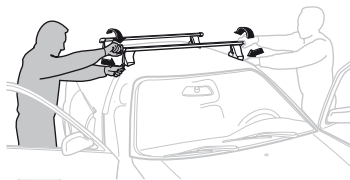
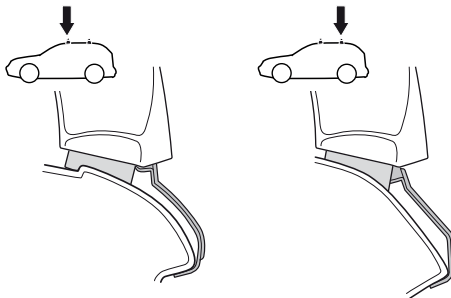
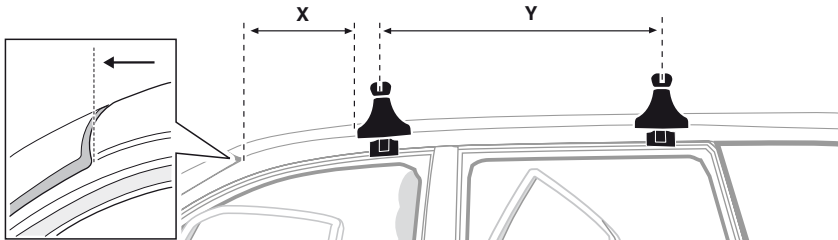

**GB/US** Tighten alternately

**D** Die Schrauben abwechselnd anziehen

**F** Serrer alternativement chaque côté

**NL** Afwisselend aan de linker- en de rechterkant aandraaien

**I** Alternare il serraggio delle viti

**E** Serrare alternativamente

**PT** Aperte alternadamente

**S** Dra åt växelvis

**FIN** Kierrä vuorotellen

**EST** Pinguldage vaheldumisi

**LAT** Pielieciet pamišus

**LIT** Užsukinėkite pakaitomis

**PL** Śruby dokręcaj naprzemiennie

**RU** Затягивайте попеременно

**CZ** Pokręťta bagażníka dokręcaj dokręcaj naprzemiennie.

**SK** Doťahujte striedavo

**SLO** Privijajte izmenično.

**HR** Naizmjenično zategnite

**HU** Egymástól függetlenül szorítandó

**GR** Σφίγγετε εναλλάξ

**TR** Dönüşümlü sıkın

**中文** 交替拧紧

**한국어** 번갈아 가며 조이십시오.

**日本語** 交互に締め付けてください。

**ไทย** ชั้้นไนแบบสลับ

6



480R/754



480

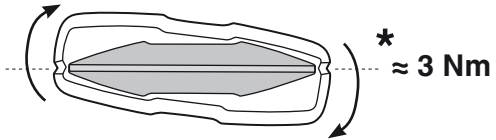
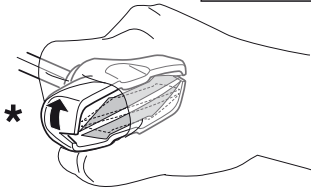
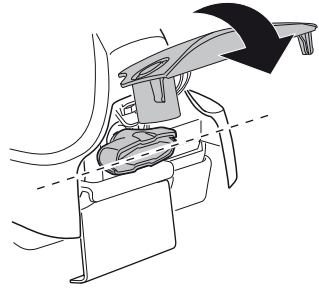
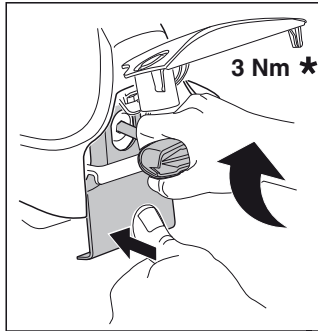
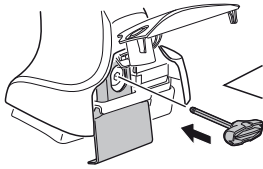

750

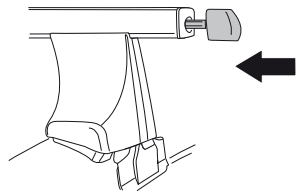
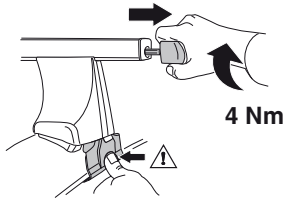

i



1

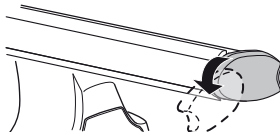

2

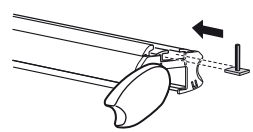

i

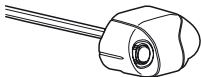

1

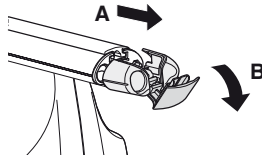

2

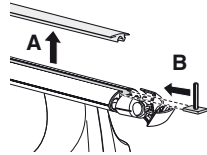

i



1

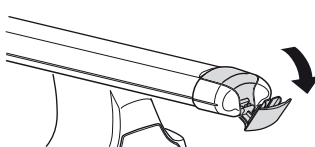

2

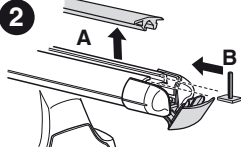

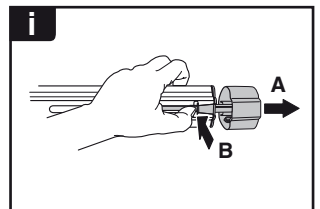
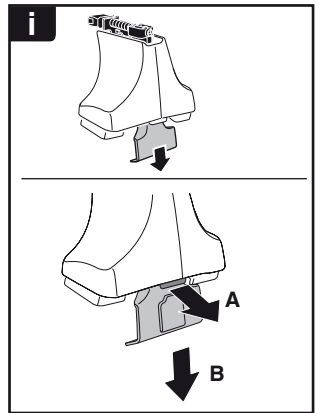
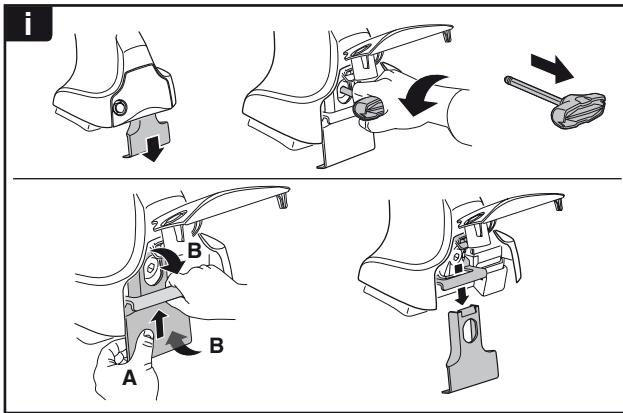
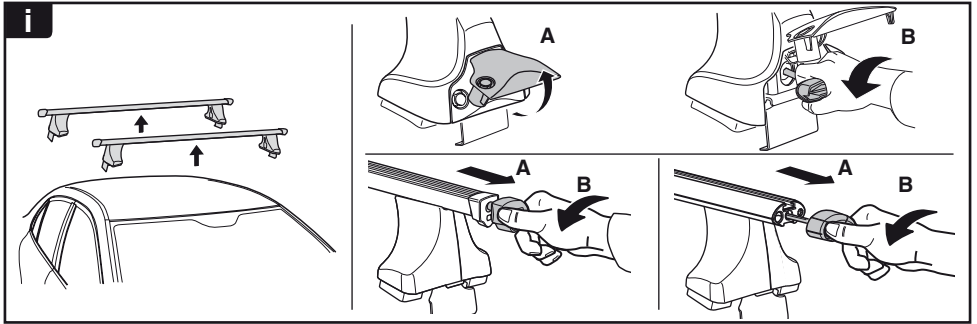

**THULE**  
SWEDEN  
**ONE  
KEY  
SYSTEM**



- 544 (x4)
- 596 (x6)
- 588 (x8)
- NA 510 (x10)
- EUR 452 (x12)
- ASIA

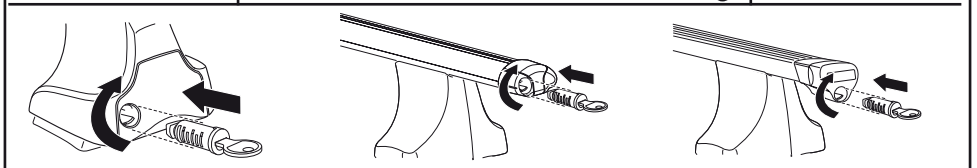

WW ▶ Thule Sweden AB, Box 69, 330 33 Hillerstorp, SWEDEN  
NA ▶ Thule Inc., 42 Silvermine Road, Seymour, Connecticut 06483, USA

info@thule.com  
customer.service@thule.com

www.thule.com