

# Kit 1518

FORD Flex, 5-dr, 09-

480R  
754

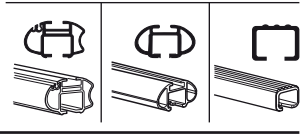

480

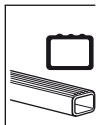

750

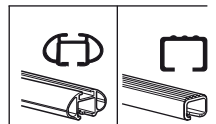
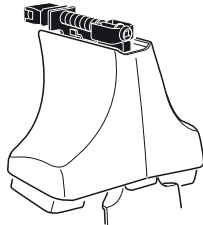

**xx kg**  
**xx lbs**

+ 7 kg  
15,4 lbs =

**Max. 50kg**  
**Max. 110 lbs**

**80 km/h**  
**50 Mph**

**130 km/h**  
**80 Mph**

**40 km/h**  
**25 Mph**

**km/h**  
**Mph**

**THULE**

**Kit XXXX**

**instructions**

**480R/754**

**x1**

**x4**

**x4**

**x4**

**480**

**x1**

**x4**

**x4**

**750**

**x1**

**x4**

**x4**

<b>x2</b>	<b>x2</b>	<b>x2</b>	<b>x2</b>	<b>x2</b>
<b>x2</b>	<b>x2</b>	<b>x2</b>	<b>x2</b>	<b>x2</b>
<b>x2</b>	<b>x2</b>	<b>x4</b>	<b>x4</b>	<b>x2</b>
<b>x4</b>		<b>x4</b>		

**1040** **x4**

**93** **x2**

**221** **x2**

**x1**

**Kit**



**3**



754

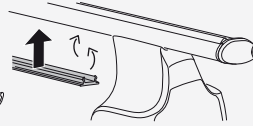
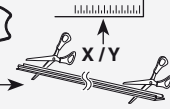

750



**1**

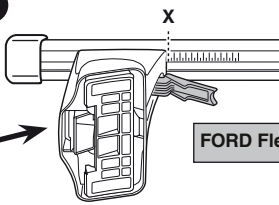

**2**

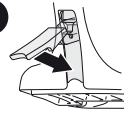

FORD Flex, 5-dr, 09–

X

53

**1**

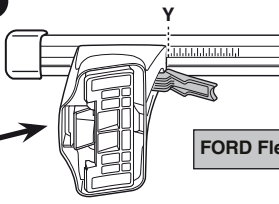

**2**

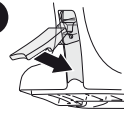

FORD Flex, 5-dr, 09–

Y

53



480R



480

**1**

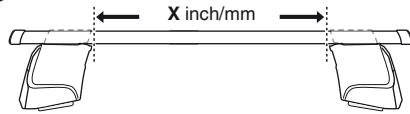

**2**

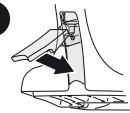

FORD Flex, 5-dr, 09–

X inch

X mm

46 1/2"

1181 mm

**1**

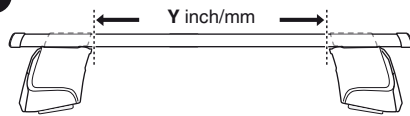

**2**

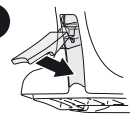

FORD Flex, 5-dr, 09–

Y inch

Y mm

46 1/2"

1181 mm

# 4

FORD Flex, 5-dr, 09–

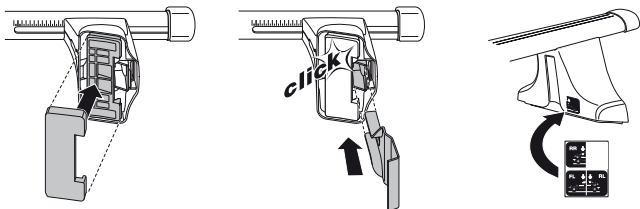
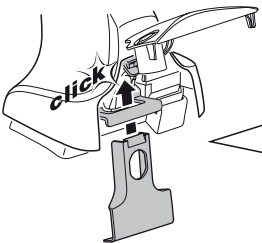
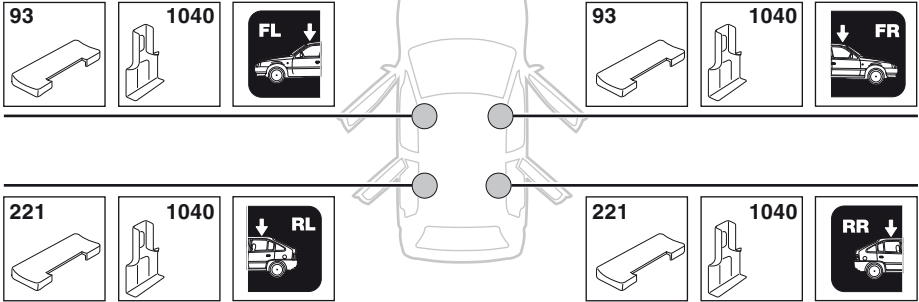

5



	X mm	Y mm	X inch	Y inch
FORD Flex, 5-dr, 09–	530 mm	760 mm	20 7/8"	30"

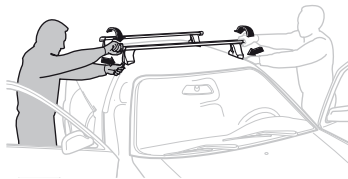
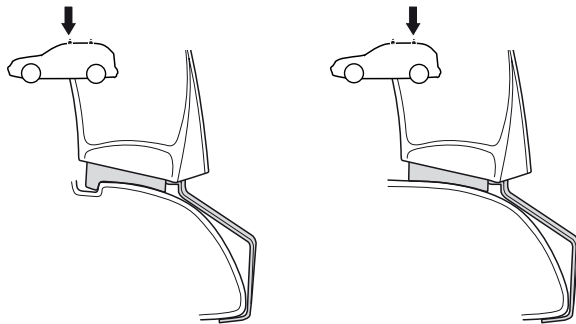
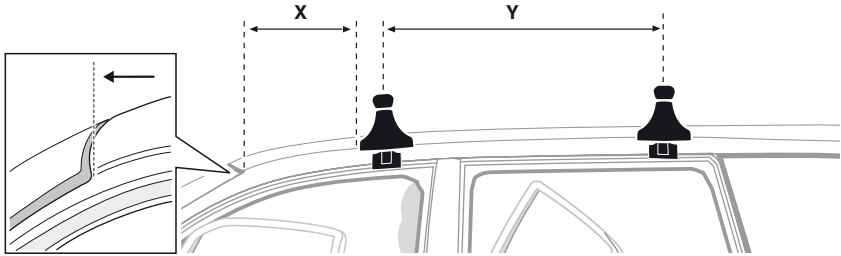

**GB/US** Tighten alternately

**D** Die Schrauben abwechselnd anziehen

**F** Serrer alternativement chaque côté

**NL** Afwisselend aan de linker- en de rechterkant aandraaien

**I** Alternare il serraggio delle viti

**E** Apertar alternativamente

**PT** Aperte alternadamente

**S** Dra åt växelvis

**FIN** Kierrä vuorotellen

**EST** Pinguldage vaheldumisi

**LAT** Pielieciet pamišus

**LIT** Užsukinėkite pakaitomis

**PL** Śruby dokręcaj naprzemiennie

**RU** Затягивайте попеременно

**CZ** Pokręťta bagažníka dokręcaj

dokręcaj naprzemiennie.

**SK** Doťahujte striedavo

**SLO** Privijajte izmenično.

**HR** Naizmjenično zategnite

**HU** Egymástól függetlenül szorítandó

**GR** Σφιγγετε εναλλάξ

**TR** Dönüşümlü sıkın

**中文** 交替拧紧

**한국어** 번갈아 가며 조이십시오.

**日本語** 交互に締め付けてください。

**ไทย** ชันโนแบบสลับ

6



480R/754



480

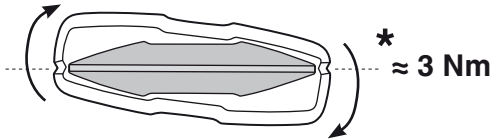
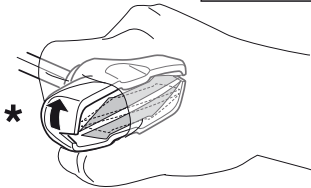
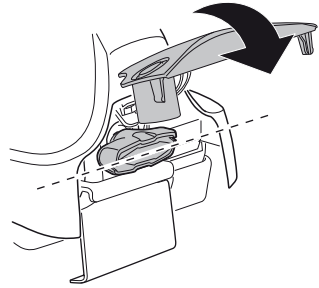
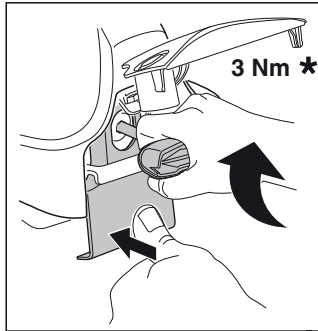

750

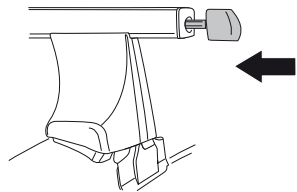
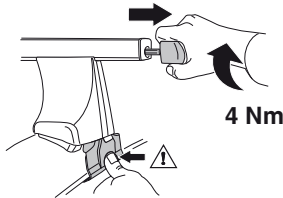

i



1



2

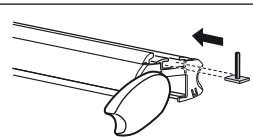

i

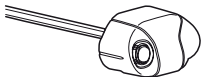

1

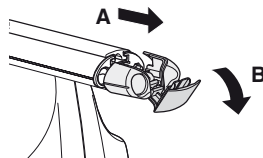

2

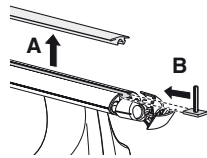

i



1

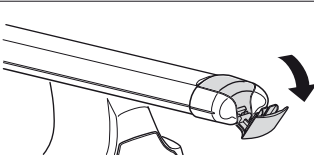

2

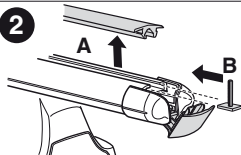

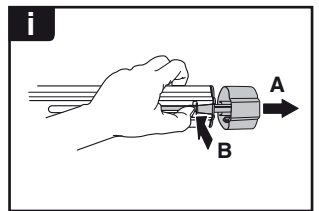
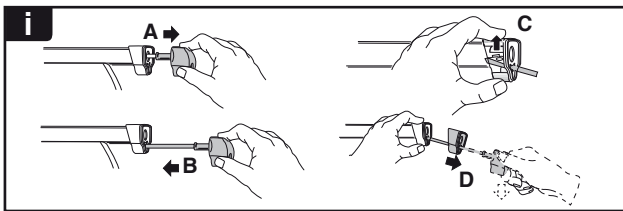
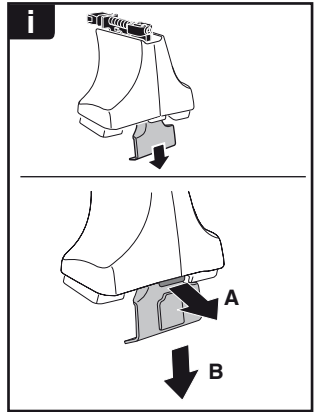
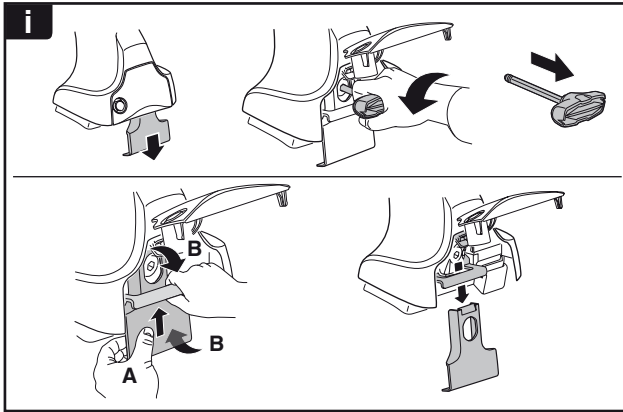

**THULE**  
SWEDEN  
**ONE  
KEY  
SYSTEM**

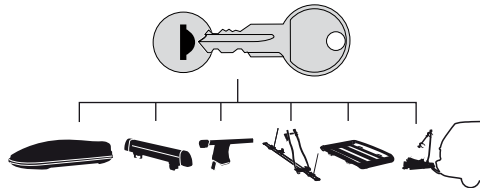

		(x4)
		(x6)
		(x8)
NA		(x10)
EUR		(x12)
ASIA		(x12)



WW ▶ Thule Sweden AB, Box 69, 330 33 Hillerstorp, SWEDEN  
NA ▶ Thule Inc., 42 Silvermine Road, Seymour, Connecticut 06483, USA

info@thule.com  
customer.service@thule.com

www.thule.com