

Kit 1545

SUBARU Exiga, 5-dr MPV, 08-

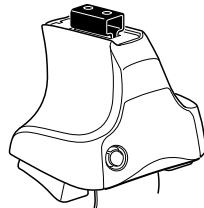

480R Rapid Traverse
754 Rapid System

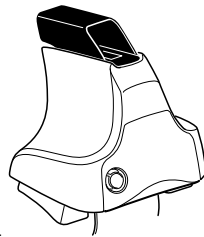
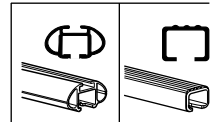

480 Traverse

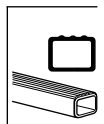

Max. 50 kg

Max. 110 lbs

km/h Mph

THULE

Kit XXXX

instructions

THULE

x1

480R Rapid Traverse x4

x4

754 Rapid System x4

x1

480 Traverse x4

x4

754 Rapid System x4

x2

x2

x2

x1

17 mm

x2

23 mm

x2

x2

x4

x4

x2

1100 x2

1101 x2

340 x1

341 x1

342 x2

x1

Kit

1



480R Rapid Traverse
754 Rapid System



480 Traverse

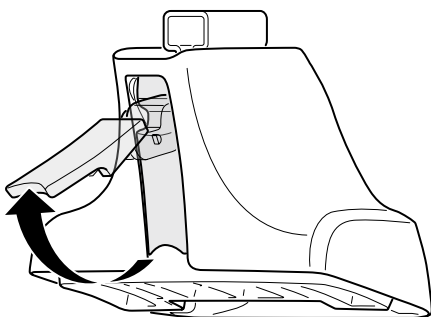

2

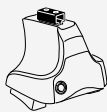

480R Rapid Traverse
754 Rapid System



480 Traverse

+

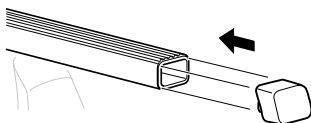
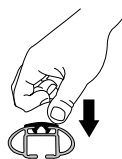
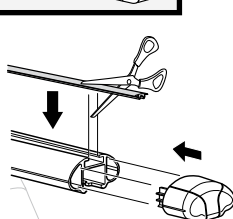
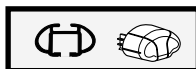
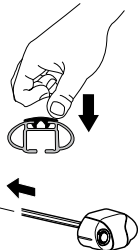
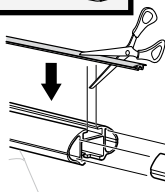
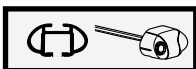
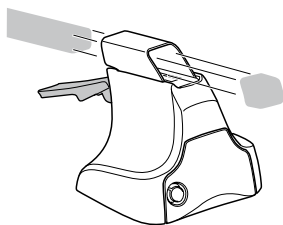
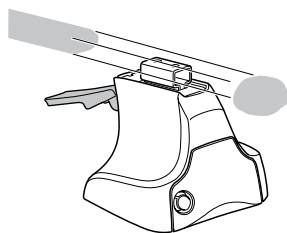

3

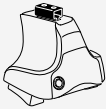

754 Rapid System

1

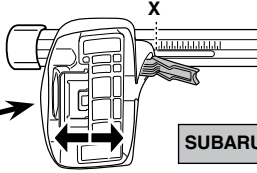
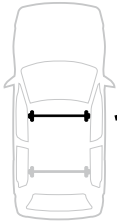

2

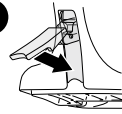

SUBARU Exiga, 5-dr MPV, 08-

X

39,5

1

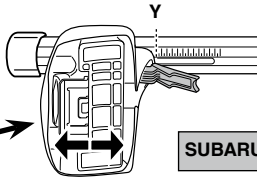
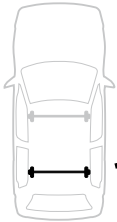

2

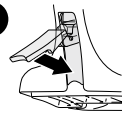

SUBARU Exiga, 5-dr MPV, 08-

Y

36



480R Rapid Traverse



480 Traverse



1

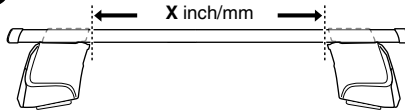

2

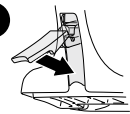

SUBARU Exiga, 5-dr MPV, 08-

X inch

X mm

41 1/8"

1045 mm

1

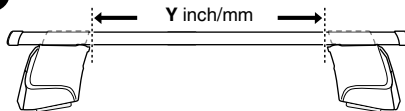

2

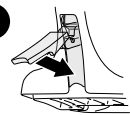

SUBARU Exiga, 5-dr MPV, 08-

Y inch

Y mm

39 7/8"

1012 mm

4

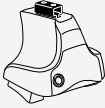

480R Rapid Traverse
754 Rapid System



480 Traverse

SUBARU Exiga, 5-dr MPV, 08-

340



1100



341

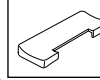

1100



342



1101



342

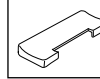

1101

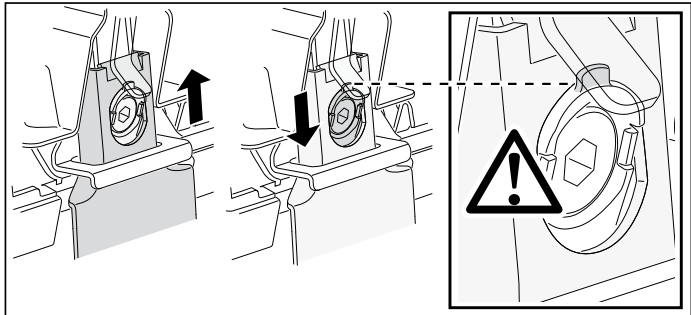
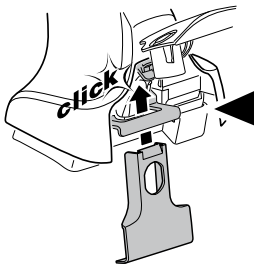
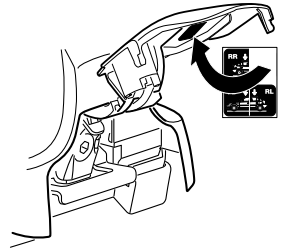
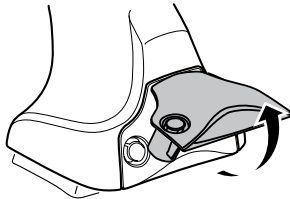
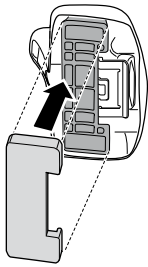

5

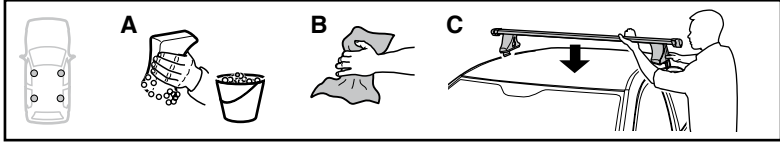

| | X mm | Y mm | X inch | Y inch |
|------------------------------------|---------------|---------------|----------------|----------------|
| SUBARU Exiga, 5-dr MPV, 08- | 445 mm | 700 mm | 17 1/2" | 27 1/2" |

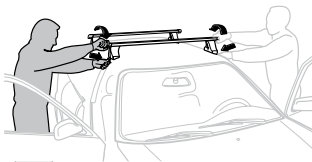
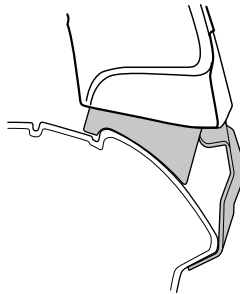
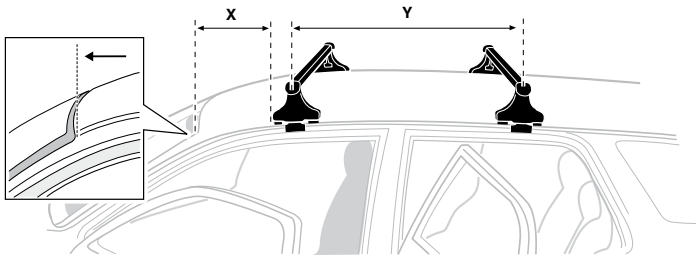

- | | | | |
|--------------|---|------------|--|
| GB/US | Tighten alternately | CZ | Pokřetla bagazníka dokřečaj dokřečaj naprziemiennie. |
| D | Die Schrauben abwechselnd anziehen | SK | Dofahujte striedavo |
| F | Serrer alternativement chaque côté | SLO | Privijajte izmenično. |
| NL | Afwisselend aan de linker- en de rechterkant aandraaien | HR | Naizmjenično zategnite |
| I | Alternare il serraggio delle viti | HU | Egymástól függetlenül szorítandó |
| E | Apretar alternativamente | GR | Σφιγχετε εναλλάξ |
| PT | Aperte alternadamente | TR | Dönüştürülü sıkın |
| S | Dra åt växelvis | 中文 | 交替拧紧 |
| FIN | Kierrä vuorotellen | 한국어 | 변갈아 가며 조이십시오. |
| EST | Pinguldage vaheldumisi | 日本語 | 交互に締め付けてください。 |
| LAT | Pielvelciet pamišus | ไทย | ขันสลับแบบสลับ |
| LIT | Užsukinėkite pakaitomis | | |
| PL | Śruby dokřečaj naprziemiennie | | |
| RU | Затягивайте попеременно | | |

6

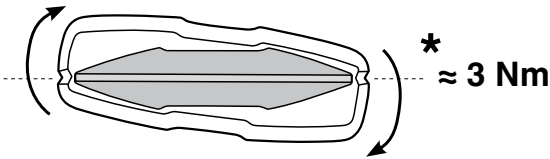
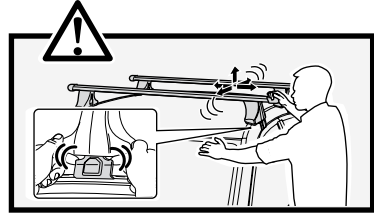
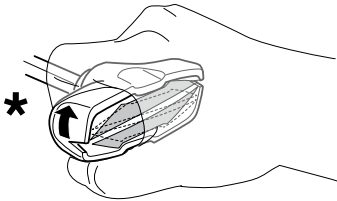
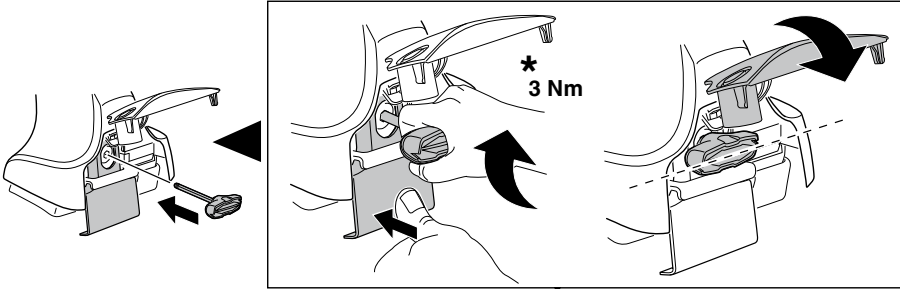
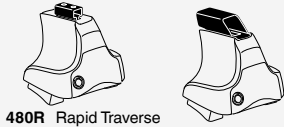

7

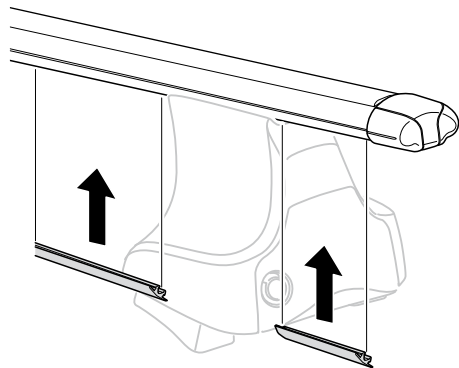
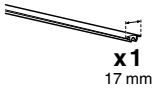

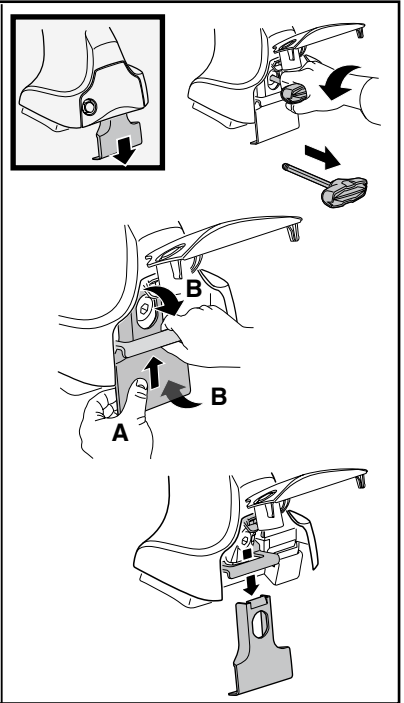
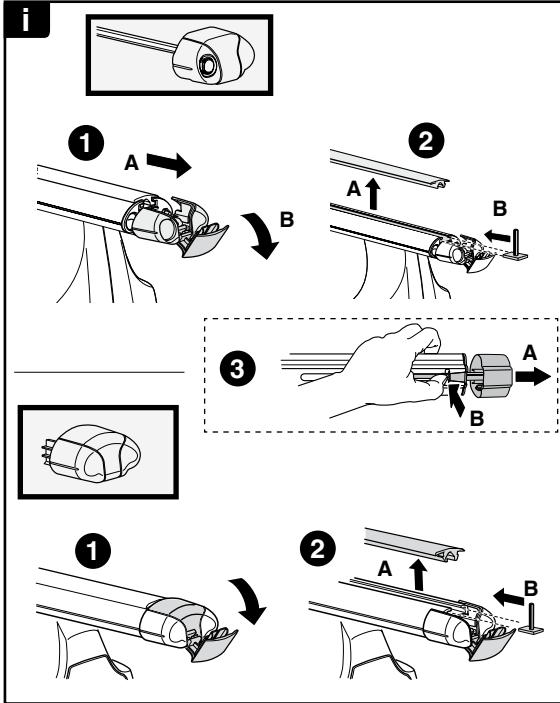
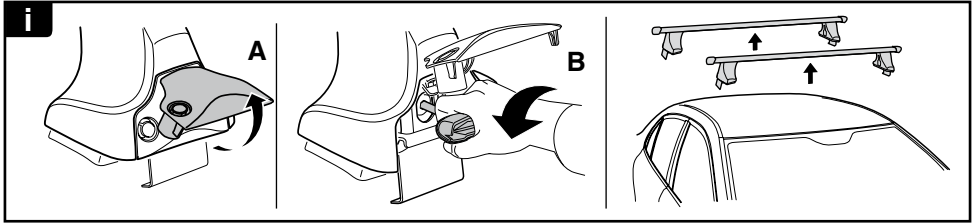

THULE
SWEDEN
**ONE
KEY
SYSTEM**

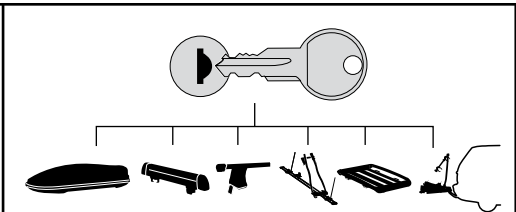

| | | |
|------|--|-------|
| | | (x4) |
| | | (x6) |
| | | (x8) |
| NA | | (x10) |
| EUR | | (x12) |
| ASIA | | |

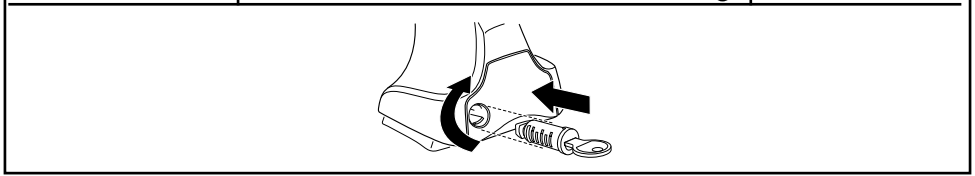

WW ▶ Thule Sweden AB, Box 69, 330 33 Hillerstorp, SWEDEN
NA ▶ Thule Inc., 42 Silvermine Road, Seymour, Connecticut 06483, USA

info@thule.com
customer.service@thule.com

www.thule.com