

Kit 1568

TOYOTA Wish, 5-dr MPV, 09-

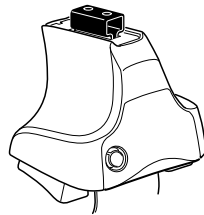

480R
754

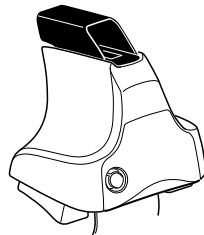
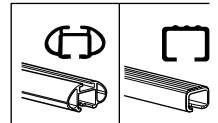

480

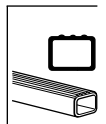

480R/754

480

Kit

1

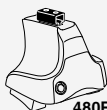

480R/754



480

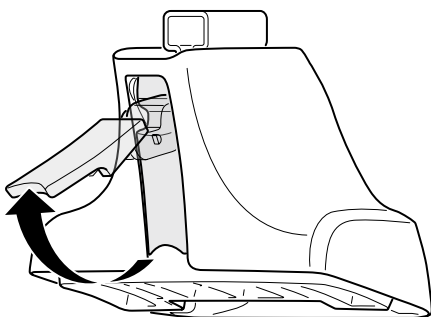

2

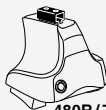

480R/754



480

+

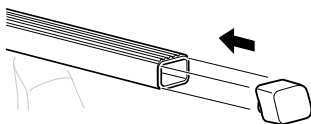
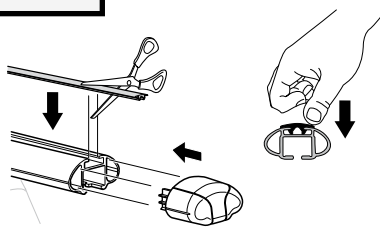
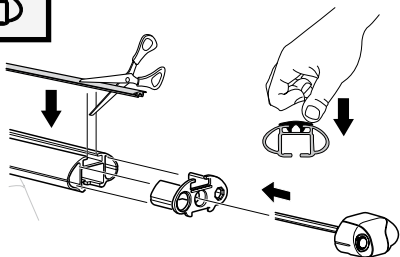
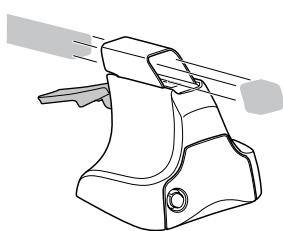
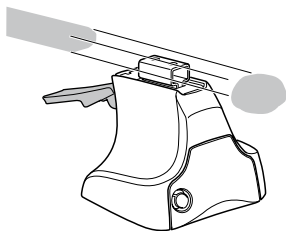

3

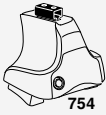

754

1

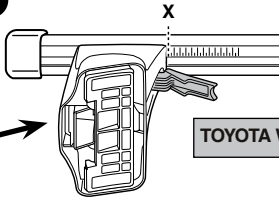
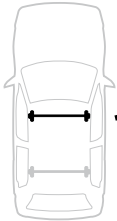

2

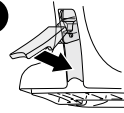

TOYOTA Wish, 5-dr MPV, 09–

X

31,5

1

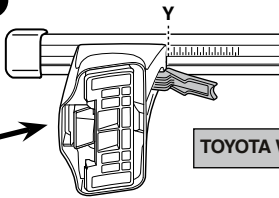

2

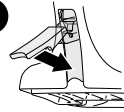

TOYOTA Wish, 5-dr MPV, 09–

Y

26



480R

480

1

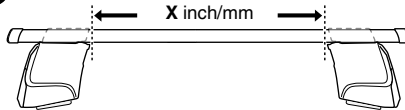

2

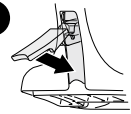

TOYOTA Wish, 5-dr MPV, 09–

X inch

X mm

38 1/8"

968 mm

1

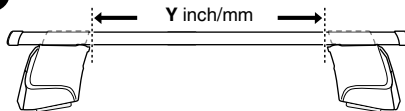

2

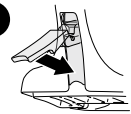

TOYOTA Wish, 5-dr MPV, 09–

Y inch

Y mm

35 7/8"

911 mm

4



480R/754



480

TOYOTA Wish, 5-dr MPV, 09-

338



1069



339



1069



170



1070



170



1070

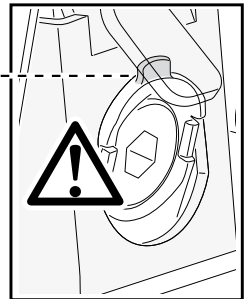
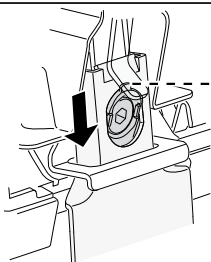
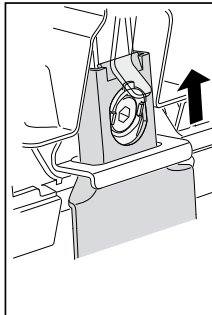
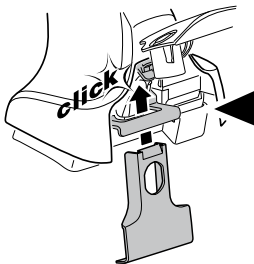
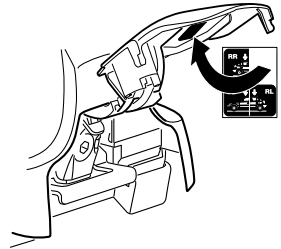
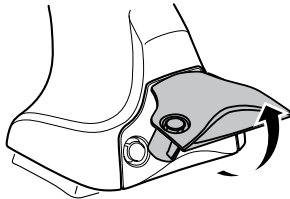
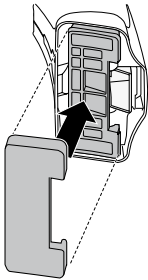

5



	X mm	Y mm	X inch	Y inch
TOYOTA Wish, 5-dr MPV, 09-	495 mm	700 mm	19 1/2"	27 1/2"

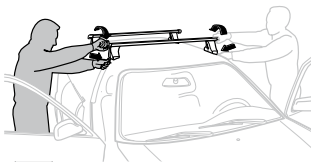
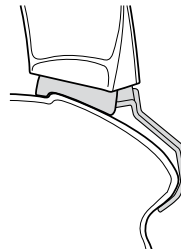
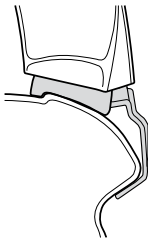
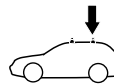
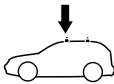
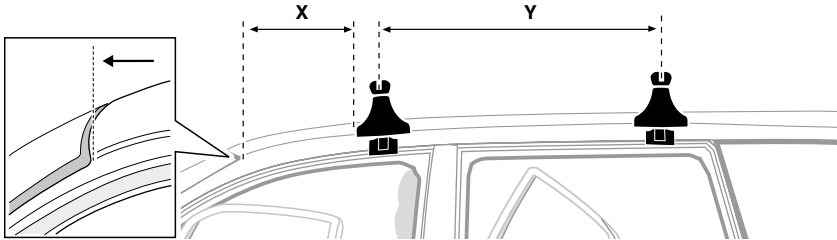

- GB/US** Tighten alternately
D Die Schrauben abwechselnd anziehen
F Serrer alternativement chaque côté
NL Afwisselend aan de linker- en de rechterkant aandraaien
I Alternare il serraggio delle viti
E Apretar alternativamente
PT Aperte alternadamente
S Dra åt växelvis
FIN Kierrä vuorotellen
EST Pinguldage vaheldumisi
LAT Pievelciēt pamišus
LIT Užsukinėkite pakaitomis
PL Śruby dokręcaj naprzemiennie
RU Затягивайте попеременно

- CZ** Pokrétla bagážnika dokręcaj dokręcaj naprzemiennie.
SK Dotiahujte striedavo
SLO Privijajte izmenično.
HR Naizmjenično zategnite
HU Egyarástól függetlenül szorítandó
GR Σφιγγετε εναλλάξ
TR Dönüşümlü sıkın

中文 交替拧紧

한국어 번갈아 가며 조이십시오.

日本語 交互に締め付けてください。

ไทย สลับขันแบบสลับ

6

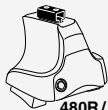

480R/754



480

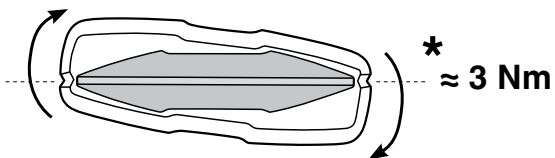
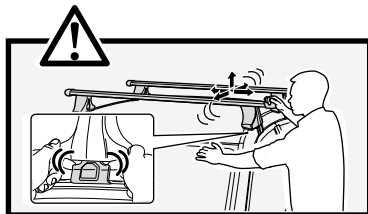
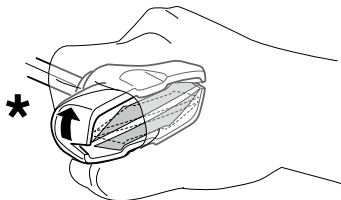
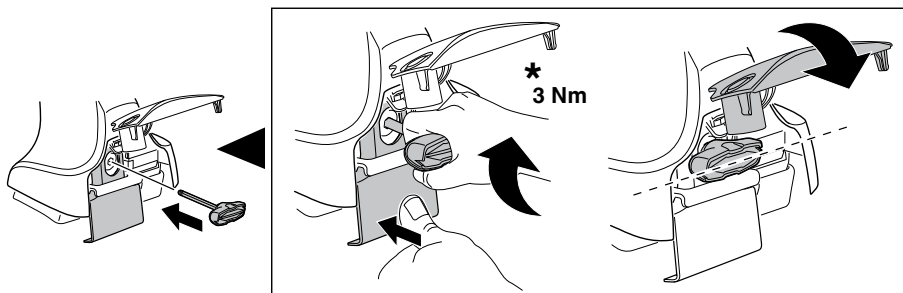

7

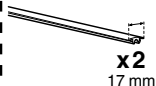

x2
17 mm

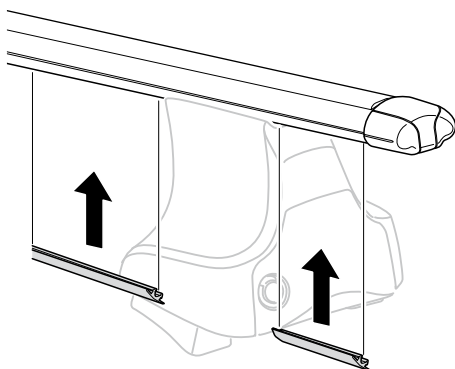

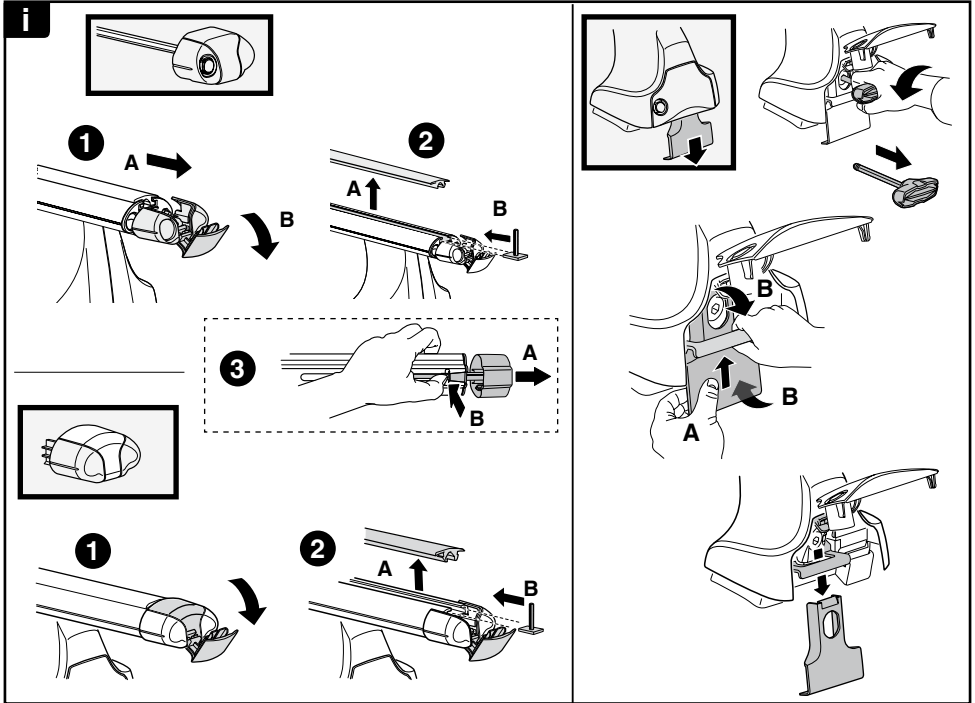

THULE
SWEDEN
**ONE
KEY
SYSTEM**

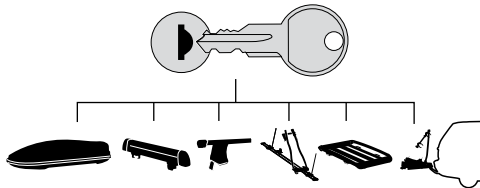

- 544** (x4)
- 596** (x6)
- 588** (x8)
- NA **510** (x10)
- EUR **452** (x12)
- ASIA

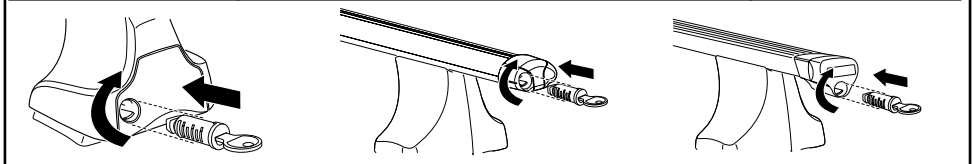

WW ▶ Thule Sweden AB, Box 69, 330 33 Hillerstorp, SWEDEN
NA ▶ Thule Inc., 42 Silvermine Road, Seymour, Connecticut 06483, USA

info@thule.com
customer.service@thule.com

www.thule.com