

# Kit 1579

KIA Forte, 4-dr Sedan, 08–

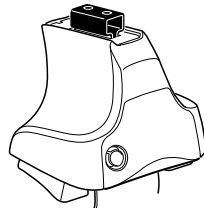

480R Rapid Traverse  
754 Rapid System

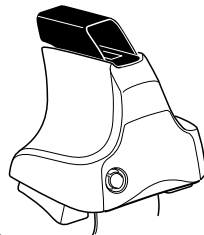
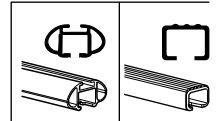

480 Traverse



**Kit**

1



480R Rapid Traverse  
754 Rapid System



480 Traverse

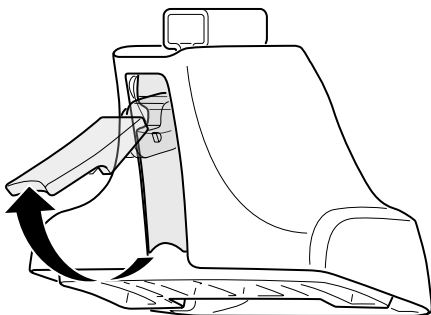

2

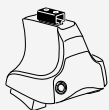

480R Rapid Traverse  
754 Rapid System



480 Traverse

+

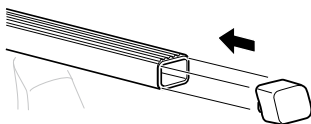
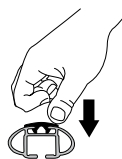
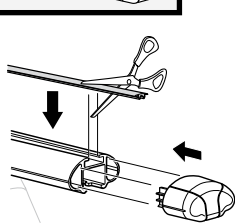
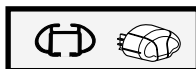
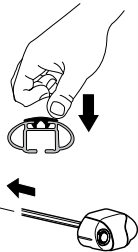
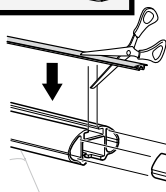
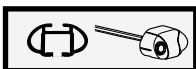
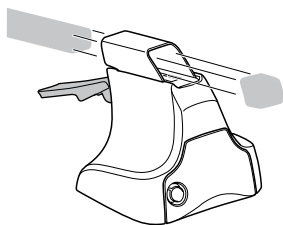
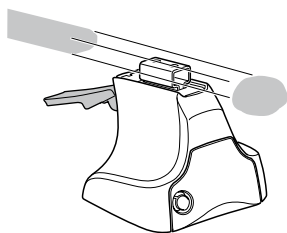

3

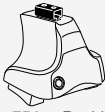

754 Rapid System

1

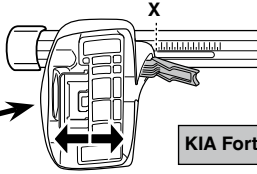
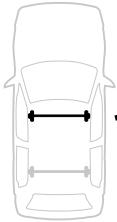

2

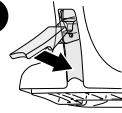

KIA Forte, 4-dr Sedan, 08-

X

38,5

1

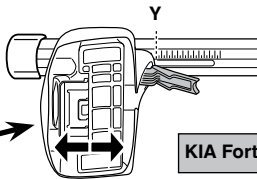

2

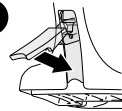

KIA Forte, 4-dr Sedan, 08-

Y

36,5



480R Rapid Traverse



480 Traverse

1

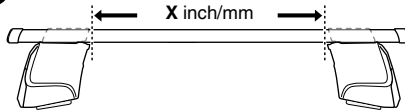

2

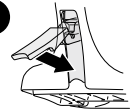

KIA Forte, 4-dr Sedan, 08-

X inch

X mm

40 3/4"

1036 mm

1

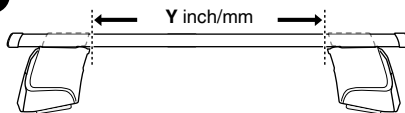

2

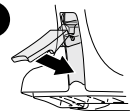

KIA Forte, 4-dr Sedan, 08-

Y inch

Y mm

40"

1015 mm

4



480R Rapid Traverse  
754 Rapid System



480 Traverse

KIA Forte, 4-dr Sedan, 08-

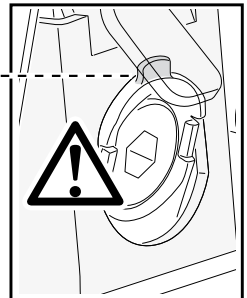
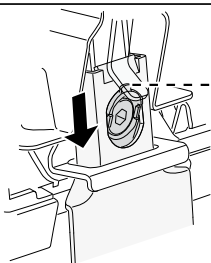
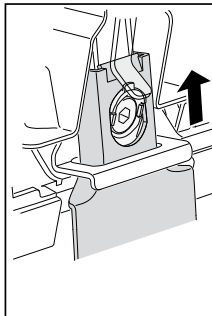
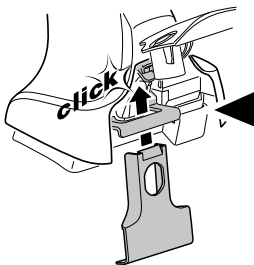
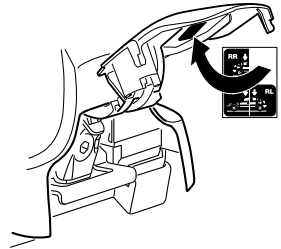
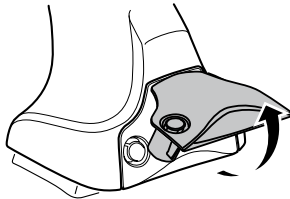
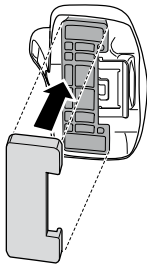
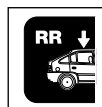
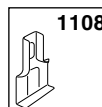
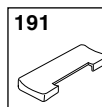
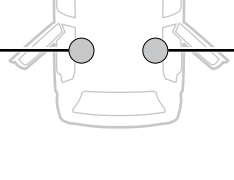
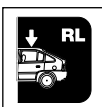
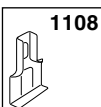
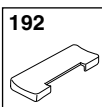
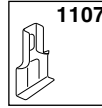
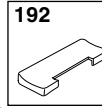
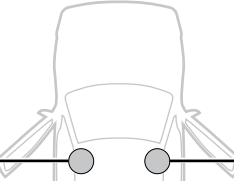
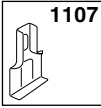
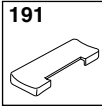

5



	X mm	Y mm	X inch	Y inch
KIA Forte, 4-dr Sedan, 08-	260 mm	660 mm	10 1/4"	26"

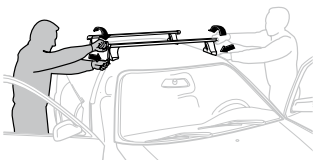
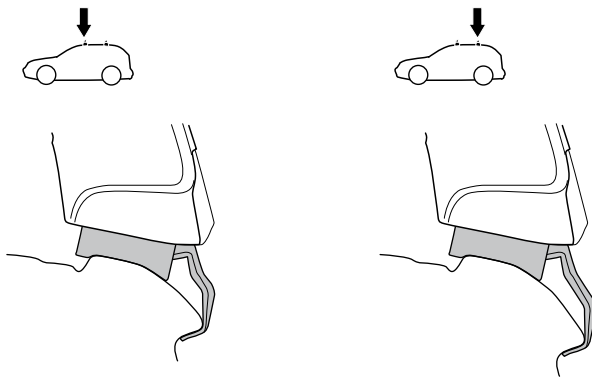
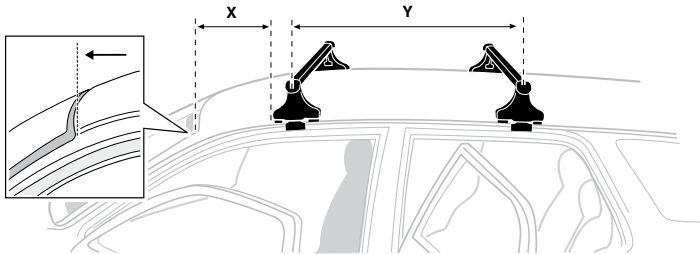

**GB/US** Tighten alternately

**D** Die Schrauben abwechselnd anziehen

**F** Serrer alternativement chaque côté

**NL** Afwisselend aan de linker- en de rechterkant aandraaien

**I** Alternare il serraggio delle viti

**E** Apretar alternativamente

**PT** Aperte alternadamente

**S** Dra åt växelvis

**FIN** Kierrä vuorotellen

**EST** Pinguldage vaheldumisi

**LAT** Pieļcielt pamāšus

**LIT** Užsukinėkite pakaitomis

**PL** Śruby dokręcaj naprzemiennie

**RU** Затягивайте попеременно

**CZ** Pokrétla bagażnika dokręcaj dokręcaj naprzemiennie.

**SK** Dotahujte striedavo

**SLO** Privijajte izmenično.

**HR** Naizmjenočno zategnite

**HU** Egy mástól függetlenül szorítandó

**GR** Σφιγγετε εναλλάξ

**TR** Dönüşümlü sıkın

**中文** 交替拧紧

**한국어** 번갈아 가며 조이십시오.

**日本語** 交互に締め付けてください。

**ไทย** ชนในแบบสลับ

6

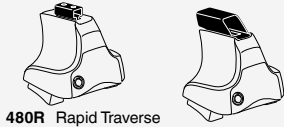

480R Rapid Traverse  
754 Rapid System    480 Traverse

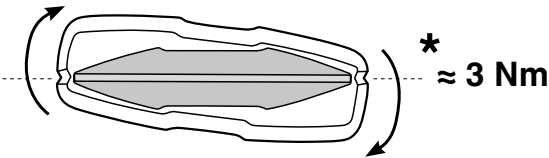
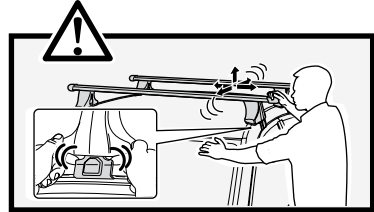
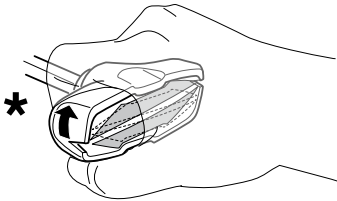
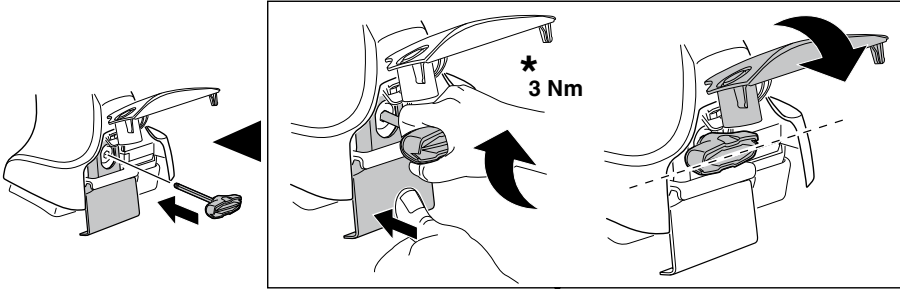

7

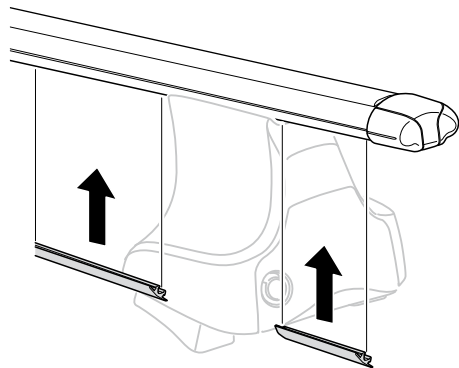
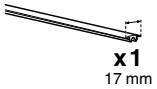

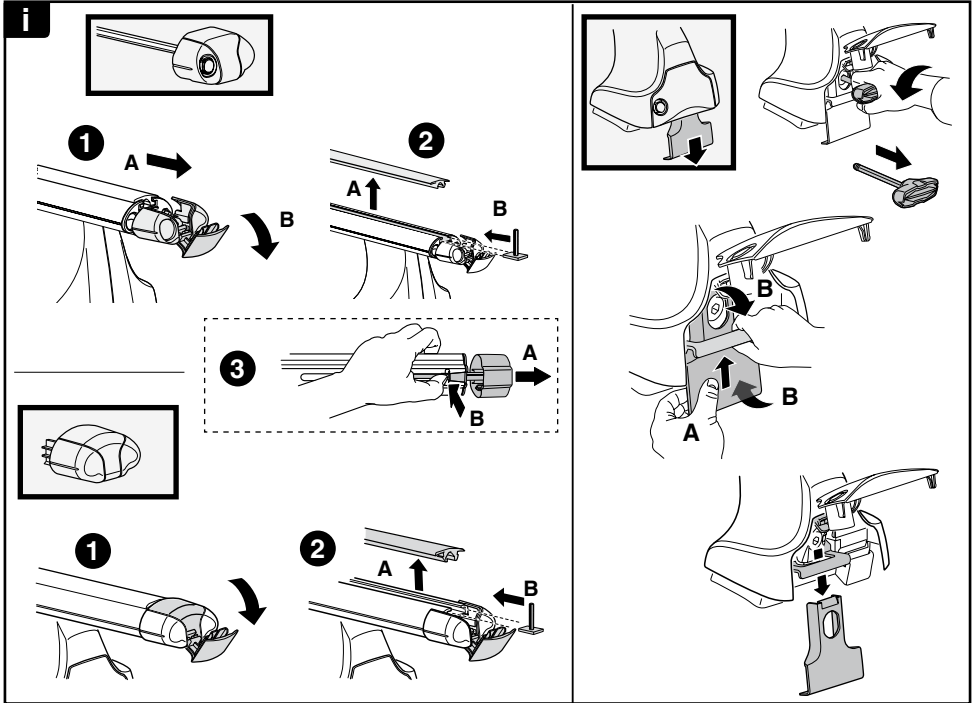

**THULE**  
SWEDEN  
**ONE  
KEY  
SYSTEM**

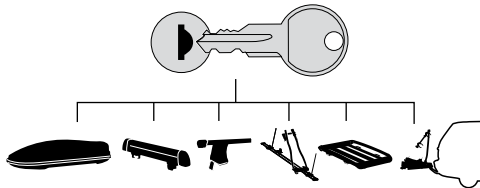

- 544** (x4)
- 596** (x6)
- 588** (x8)
- NA **510** (x10)
- EUR **452** (x12)
- ASIA

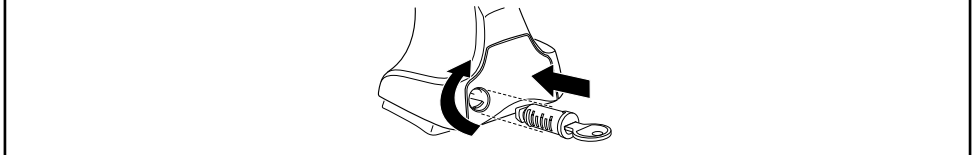

WW ▶ Thule Sweden AB, Box 69, 330 33 Hillerstorp, SWEDEN  
NA ▶ Thule Inc., 42 Silvermine Road, Seymour, Connecticut 06483, USA

info@thule.com  
customer.service@thule.com

www.thule.com