

Kit 1584

KIA Venga, 5-dr Hatchback, 10-

KIA Venga, 5-dr Hatchback, 10- (with glassroof)

480R
754

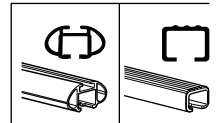
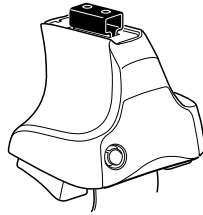

480

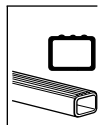
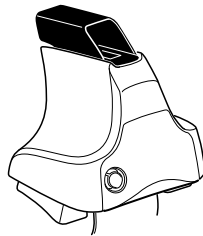

480R/754

480

Kit

1

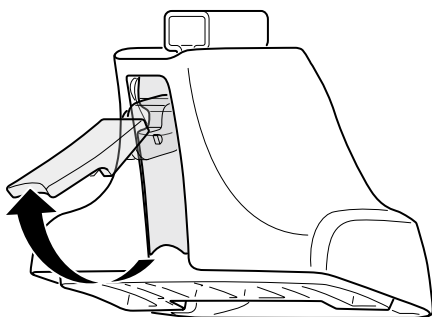
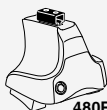

2



+

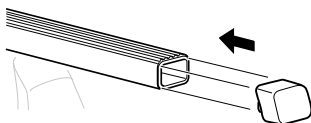
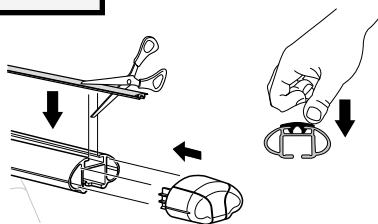
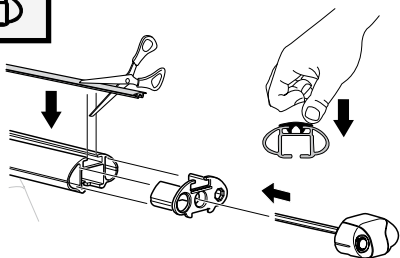
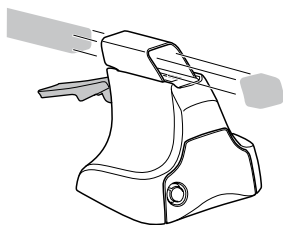
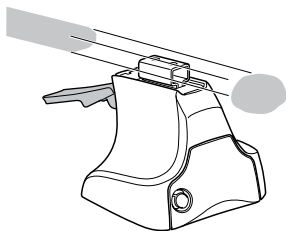

3

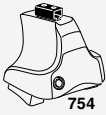

754

1

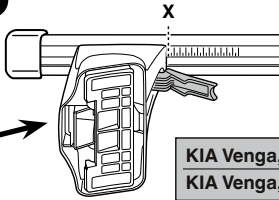
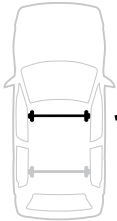

2

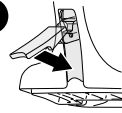

	X
KIA Venga, 5-dr Hatchback, 10-	40,5
KIA Venga, 5-dr Hatchback, 10- (with glassroof)	40,5

1

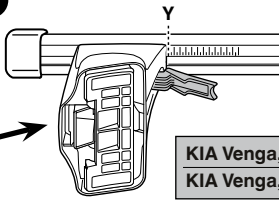

2

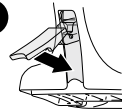

	Y
KIA Venga, 5-dr Hatchback, 10-	37
KIA Venga, 5-dr Hatchback, 10- (with glassroof)	37,5



480R



480



1

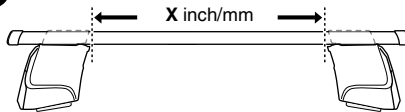

2

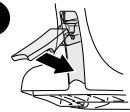

	X inch	X mm
KIA Venga, 5-dr Hatchback, 10-	41 ⁵ / ₈ "	1056 mm
KIA Venga, 5-dr Hatchback, 10- (with glassroof)	41 ⁵ / ₈ "	1056 mm

1

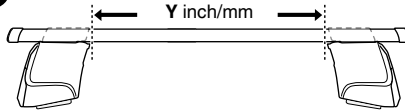

2

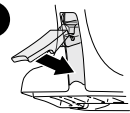

	Y inch	Y mm
KIA Venga, 5-dr Hatchback, 10-	40 "	1021 mm
KIA Venga, 5-dr Hatchback, 10- (with glassroof)	40 ³ / ₈ "	1026 mm

4

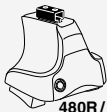

480R/754



480

KIA Venga, 5-dr Hatchback, 10-
KIA Venga, 5-dr Hatchback, 10- (with glassroof)

204



1062



FL



206



1062



FR



168



1063



RL



168



1063



RR

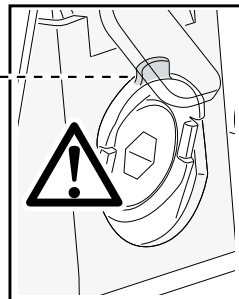
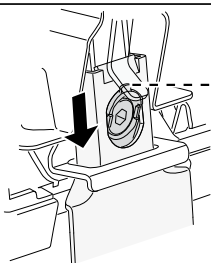
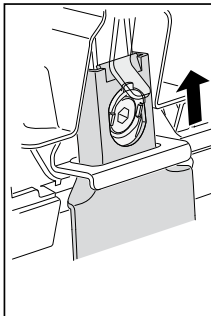
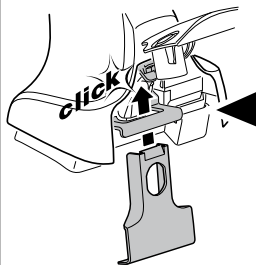
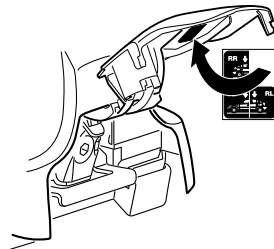
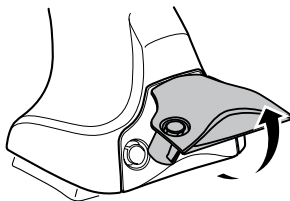
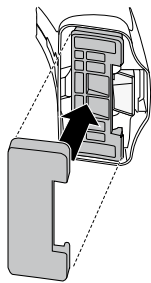

5

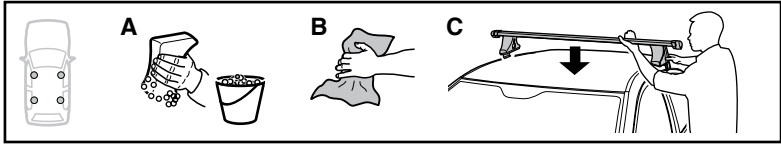

	X mm	Y mm	X inch	Y inch
KIA Venga, 5-dr Hatchback, 10-	270 mm	635 mm	10 ⁵ / ₈ "	24 ⁷ / ₈ "
KIA Venga, 5-dr Hatchback, 10- (with glassroof)	175 mm	620 mm	6 ⁷ / ₈ "	24 ³ / ₈ "

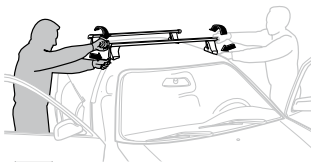
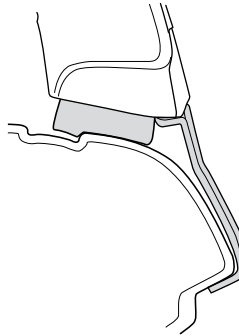
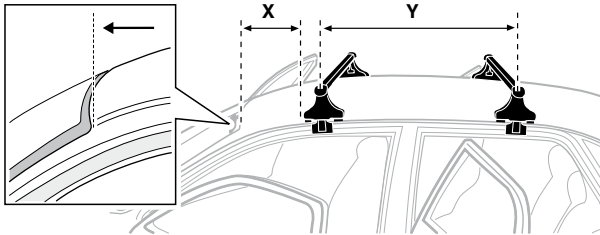

- | | | | |
|--------------|---|------------|---|
| GB/US | Tighten alternately | CZ | Pokřetla bagážníka dokřečaj dokřečaj napřezemennie. |
| D | Die Schrauben abwechselnd anziehen | SK | Dotahujte striedavo |
| F | Serrer alternativement chaque côté | SLO | Privijajte izmenično. |
| NL | Afwisselend aan de linker- en de rechterkant aandraaien | HR | Naizmjenično zategnîte |
| I | Alternare il serraggio delle viti | HU | Egymástól függetlenül szorítandó |
| E | Apretar alternativamente | GR | Σφιγγετε εναλλάξ |
| PT | Aperte alternadamente | TR | Dönüşümlü sıkın |
| S | Dra åt växelvis | 中文 | 交替拧紧 |
| FIN | Kierrä vuorotellen | 한국어 | 번갈아 가며 조이십시오. |
| EST | Pinguldage vaheldumisi | 日本語 | 交互に締め付けてください。 |
| LAT | Pievēlciēt pamišus | ไทย | ขันในแบบสลับ |
| LIT | Užsukinėkite pakaitomis | | |
| PL | Śruby dokręcaj naprzemiennie | | |
| RU | Затягивайте попеременно | | |

6

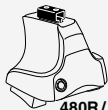

480R/754



480

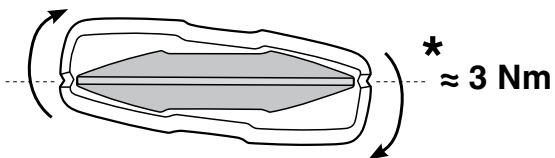
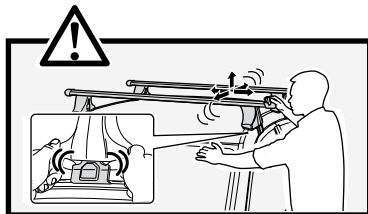
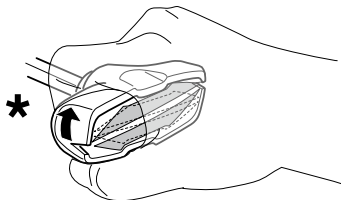
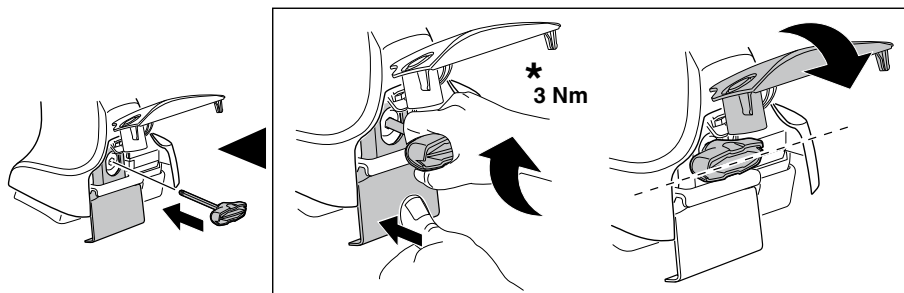

7

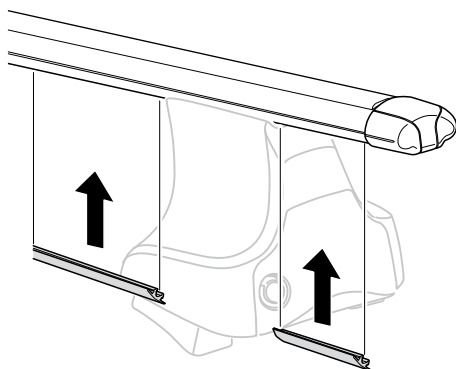
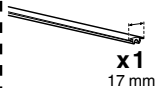

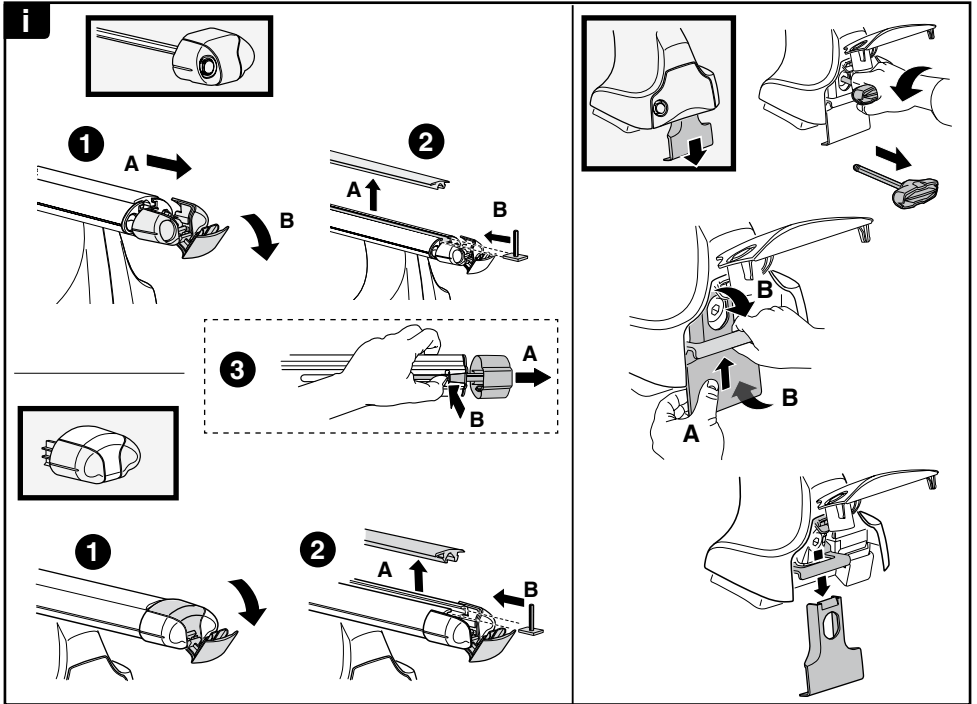
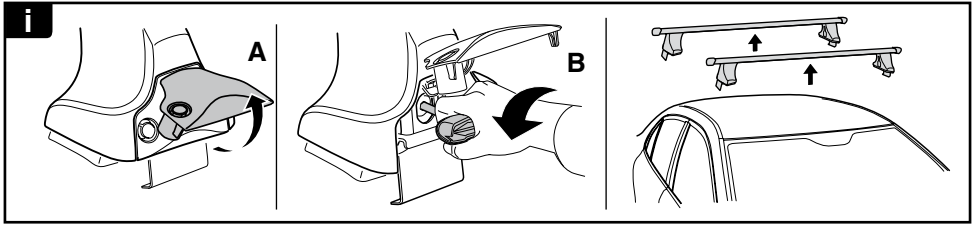

THULE
SWEDEN

**ONE
KEY
SYSTEM**

		(x4)
		(x6)
		(x8)
NA		(x10)
EUR		(x12)
ASIA		