

# Kit 1611

FIAT 500, 3-dr Hatchback, 07-\*

\* without glass roof

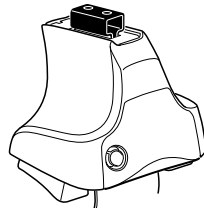

480R Rapid Traverse  
754 Rapid System

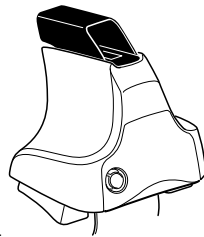
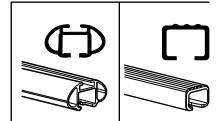

480 Traverse

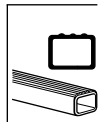

**Max. 50 kg**  
**Max. 110 lbs**

**Kit XXXX**  
 instructions

**x1**

**x4**

**x4**

**480R Rapid Traverse**  
**754 Rapid System**

---

**x1**

**x4**

**x4**

**480 Traverse**

**x2**

**x2** 23 mm

**x1** 17 mm

**x2** 23 mm

**x2** 23 mm

**x2**

**x4**

**x4**

**x2**

**x2**

**x2**

**x2**

**x4**

**x4**

**1099 x2**

**932 x2**

**137 x4**

**x1**

**Kit**

1

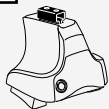

480R Rapid Traverse  
754 Rapid System



480 Traverse

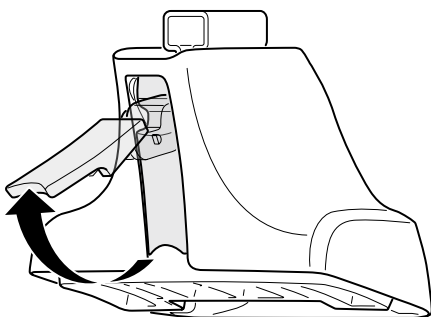

2

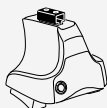

480R Rapid Traverse  
754 Rapid System



480 Traverse

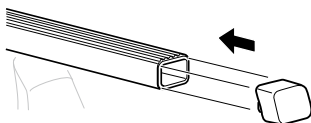
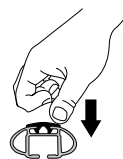
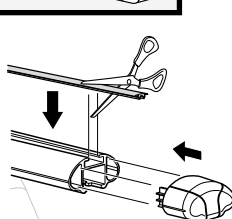
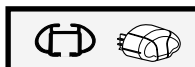
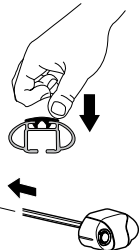
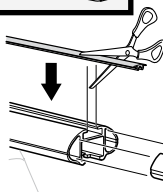
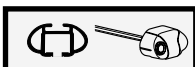
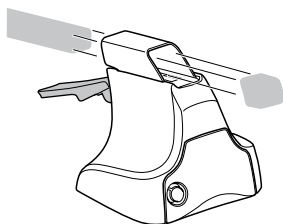
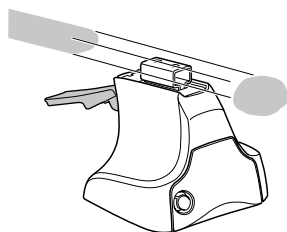

**3**

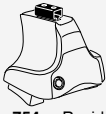

754 Rapid System

**1**

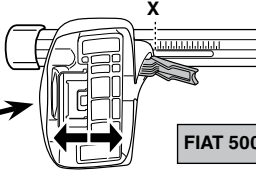
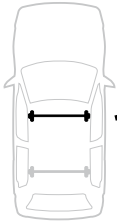

**2**

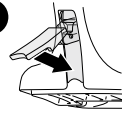

FIAT 500, 3-dr Hatchback, 07-

X

33,5

**1**

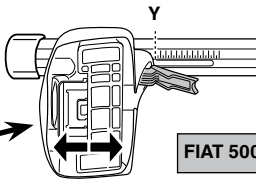
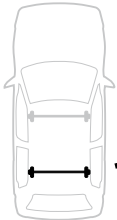

**2**

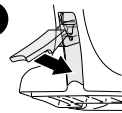

FIAT 500, 3-dr Hatchback, 07-

Y

28



480R Rapid Traverse



480 Traverse

**1**

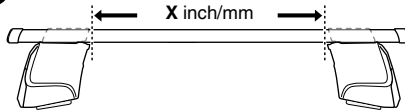

**2**

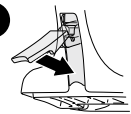

FIAT 500, 3-dr Hatchback, 07-

X inch

X mm

38 <sup>7</sup>/<sub>8</sub> "

986 mm

**1**

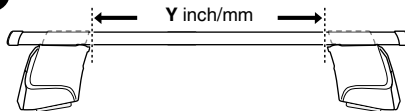

**2**

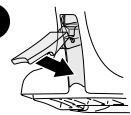

FIAT 500, 3-dr Hatchback, 07-

Y inch

Y mm

36 <sup>5</sup>/<sub>8</sub> "

931 mm

4

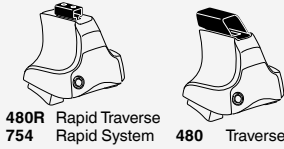

FIAT 500, 3-dr Hatchback, 07-

SRA

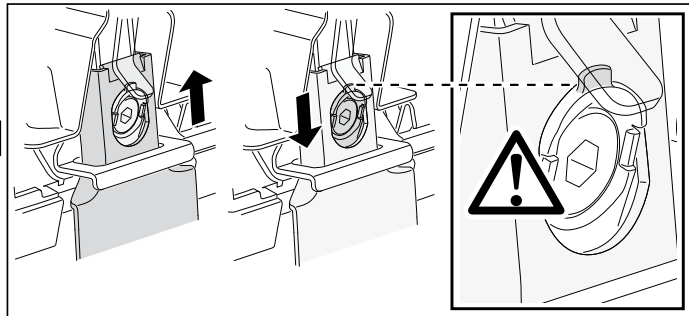
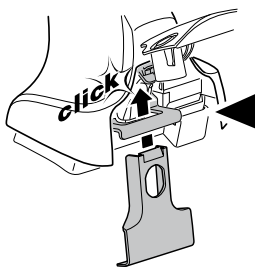
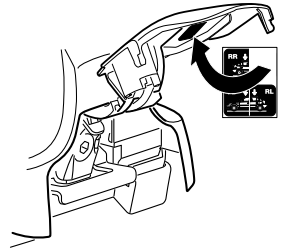
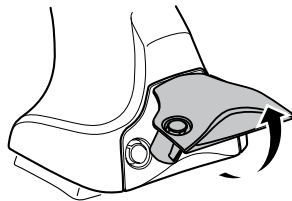
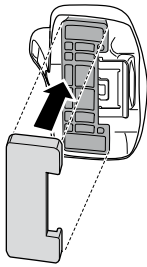
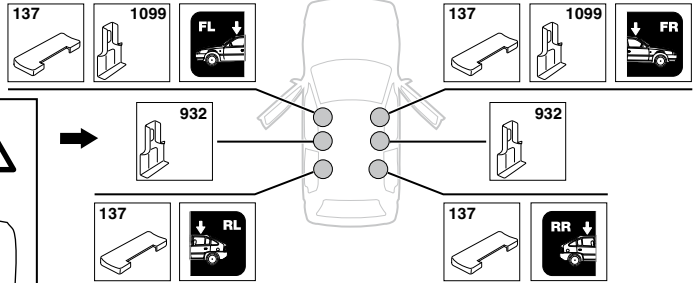
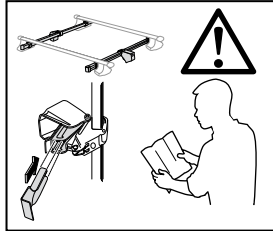

5

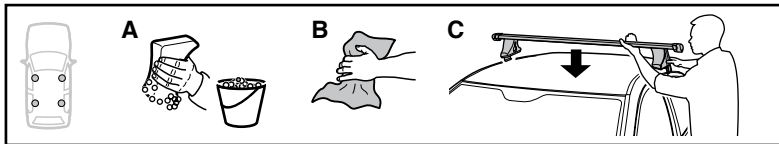

	X mm	Y mm	Z mm	X inch	Y inch	Z inch
FIAT 500, 3-dr Hatchback, 07-	225 mm	600 mm	350 mm	8 7/8"	23 5/8"	13 3/4"

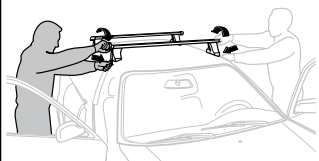
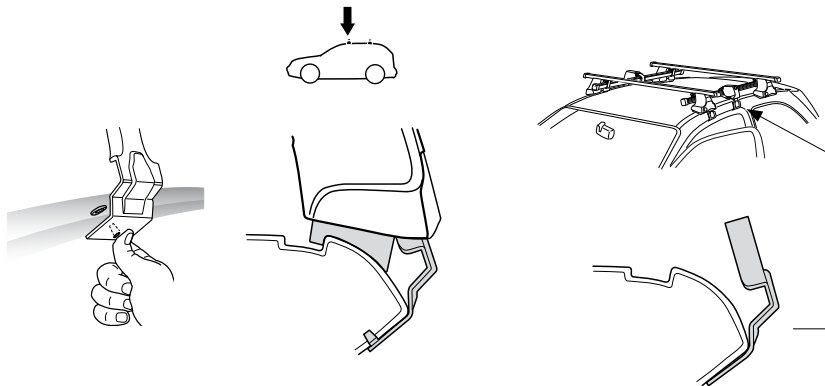
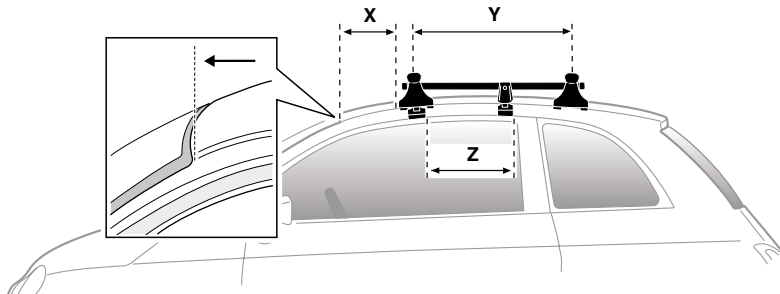

**GB/US** Tighten alternately

**D** Die Schrauben abwechselnd anziehen

**F** Serrer alternativement chaque côté

**NL** Afwisselend aan de linker- en de rechterkant aandraaien

**I** Alternare il serraggio delle viti

**E** Apretar alternativamente

**PT** Aperte alternadamente

**S** Dra åt växelvis

**FIN** Kierrä vuorotellen

**EST** Pinguldage vaheldumisi

**LAT** Pievelciēt pamīšus

**LIT** Užsukinėkite pakaitomis

**PL** Śrubby dokręcaj naprzemiennie

**RU** Затягивайте попеременно

**CZ** Pokrétla bagażnika dokręcaj dokręcaj naprzemiennie.

**SK** Dotahujte striedavo

**SLO** Privijajte izmenično.

**HR** Naizmjениčno zategniete

**HU** Egymástól függetlenül szorítandó

**GR** Σφιγγετε εναλλάξ

**TR** Dönüşümlü sıkın

**中文** 交替拧紧

**한국어** 번갈아 가며 조이십시오.

**日本語** 交互に締め付けてください。

**ไทย** ซึ้นในแบบสลับ

6

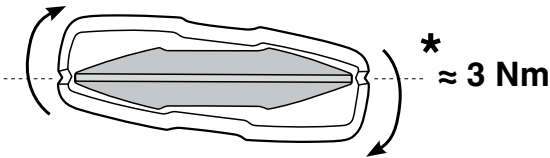
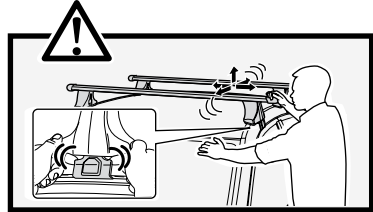
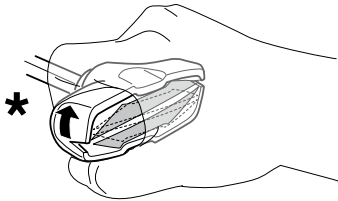
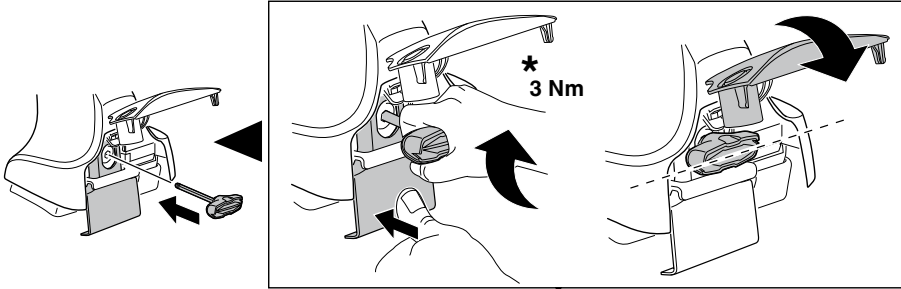
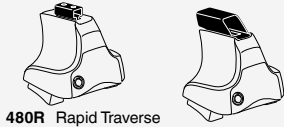

7

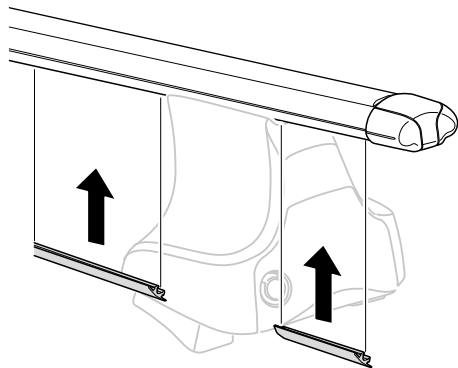
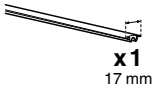

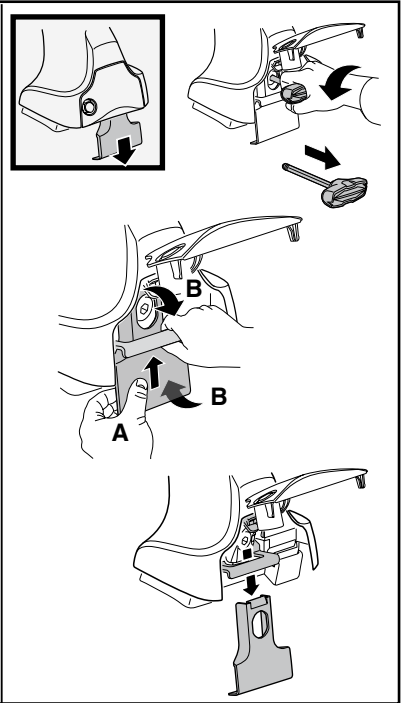
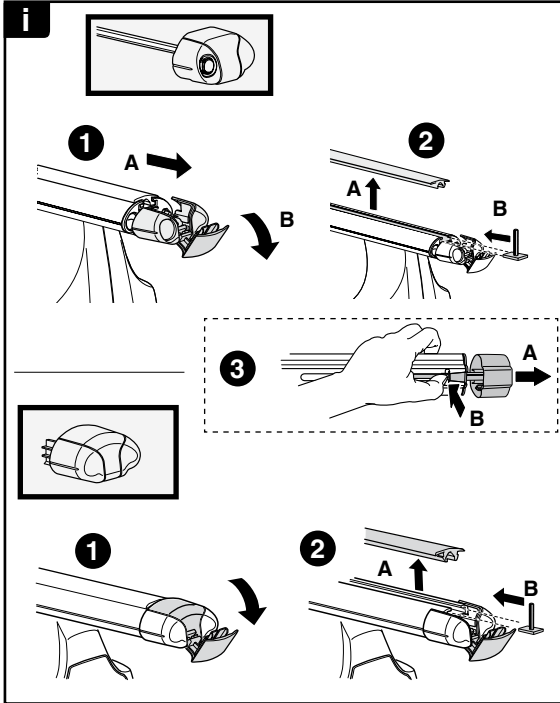

**THULE**  
SWEDEN  
**ONE  
KEY  
SYSTEM**

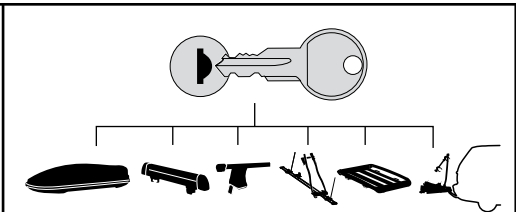

- 544 (x4)
  - 596 (x6)
  - 588 (x8)
  - 510 (x10)
  - 452 (x12)
- NA  
EUR  
ASIA



WW ▶ Thule Sweden AB, Box 69, 330 33 Hillerstorp, SWEDEN  
NA ▶ Thule Inc., 42 Silvermine Road, Seymour, Connecticut 06483, USA

info@thule.com  
customer.service@thule.com

www.thule.com